

The drawing is the property of VDM Maschinenbau AG and is to be used exclusively for the production of the described part. Any reproduction or use for other purposes is prohibited. Changes and modifications are allowed only with the approval of VDM Maschinenbau AG. All dimensions are in millimeters unless otherwise stated.

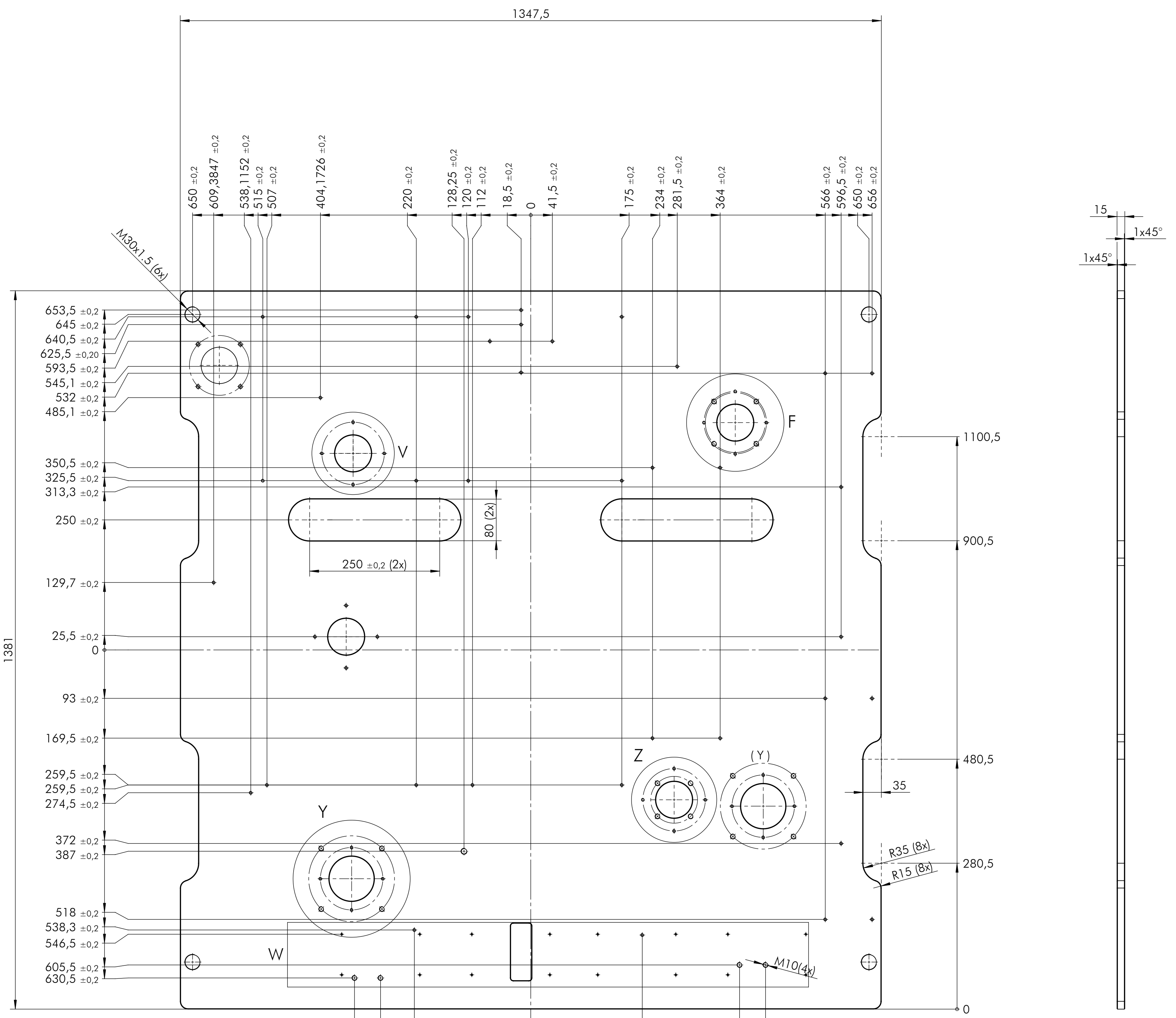

E-E

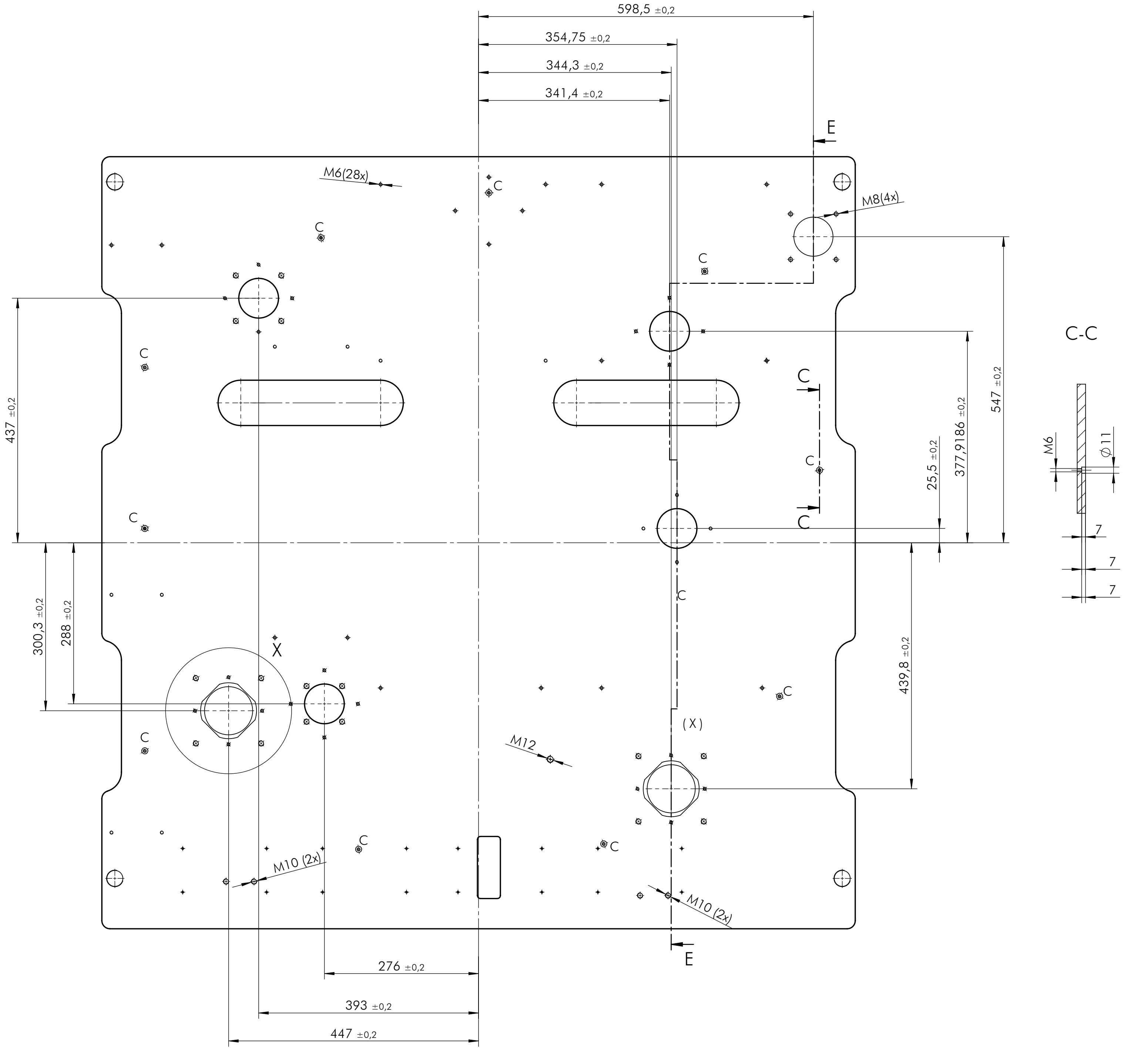
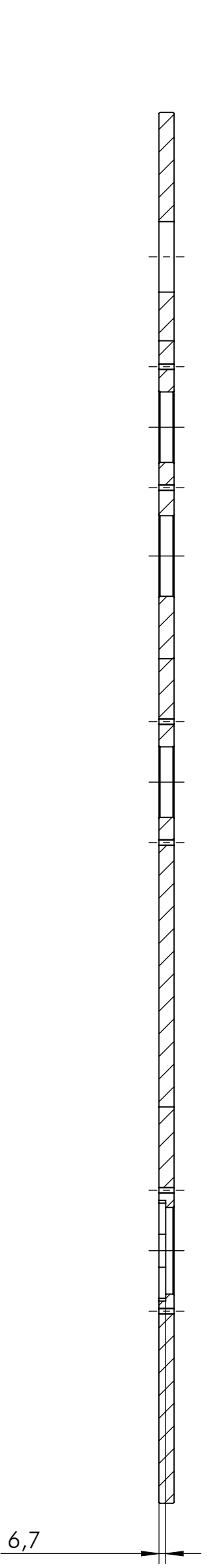

F (1 : 2) (2X)

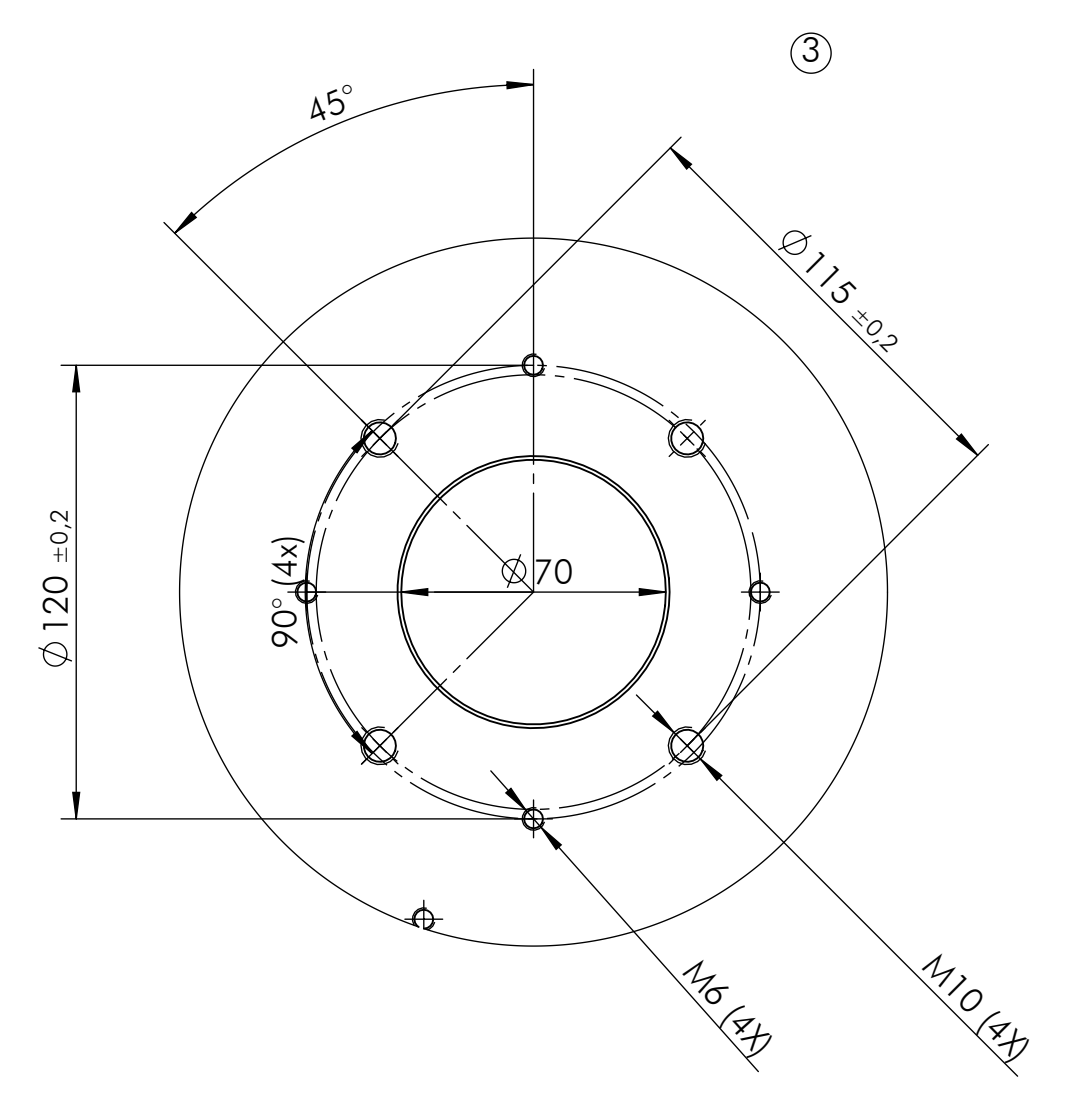

V (1 : 2) (2X)

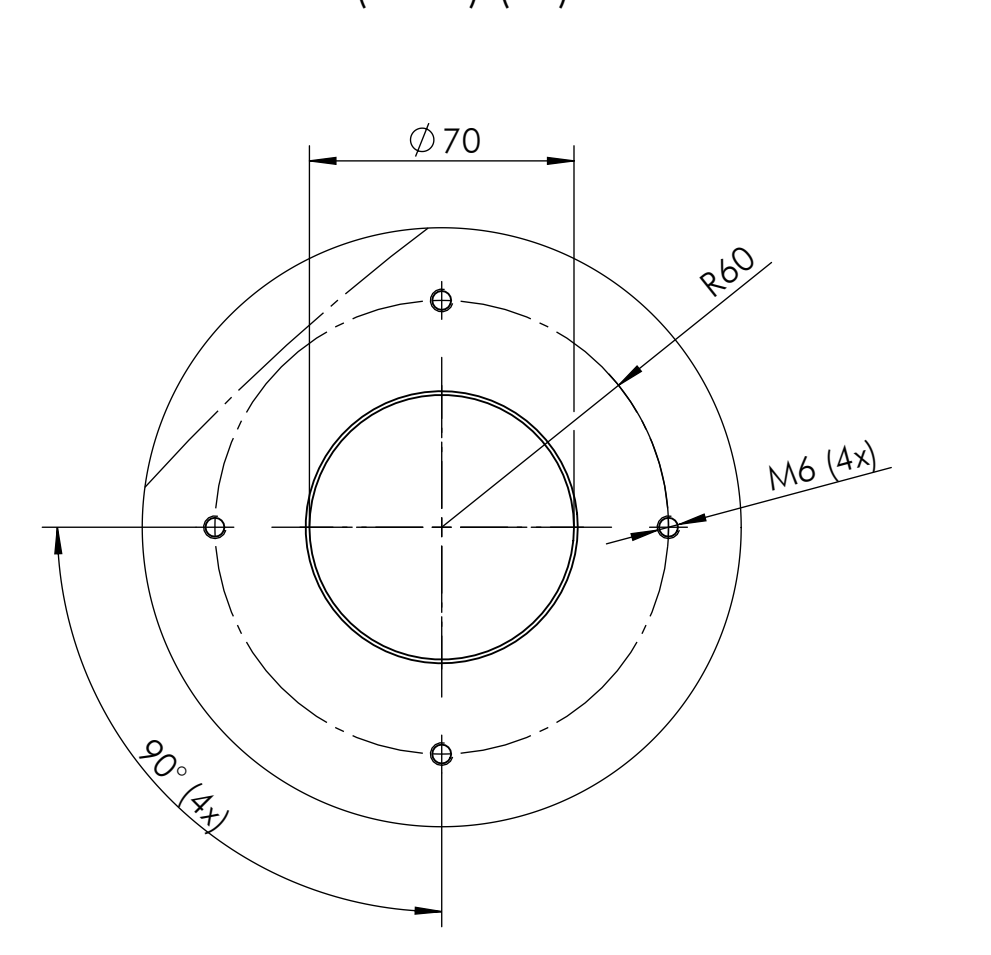

Z (1 : 2) (2X)

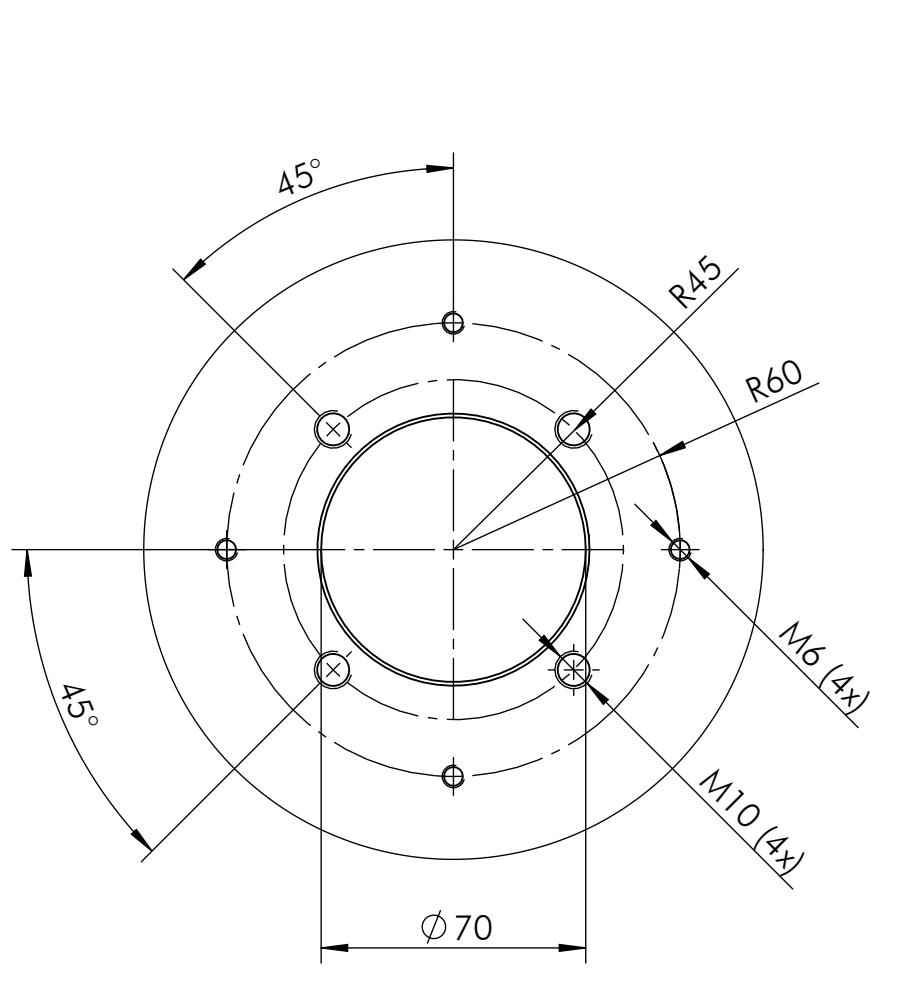

Y (1 : 2) 2x

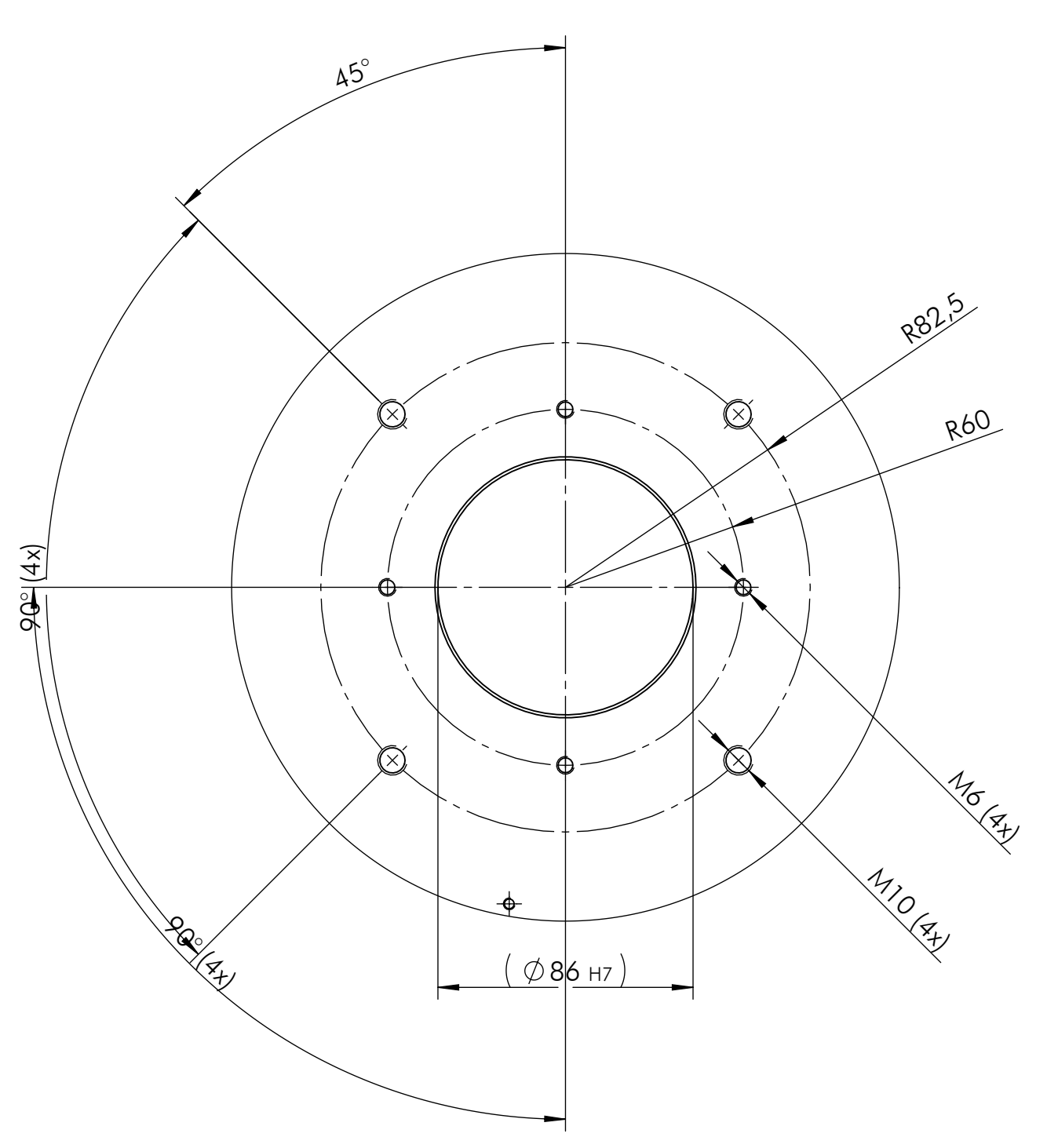

X (1 : 2) 2x

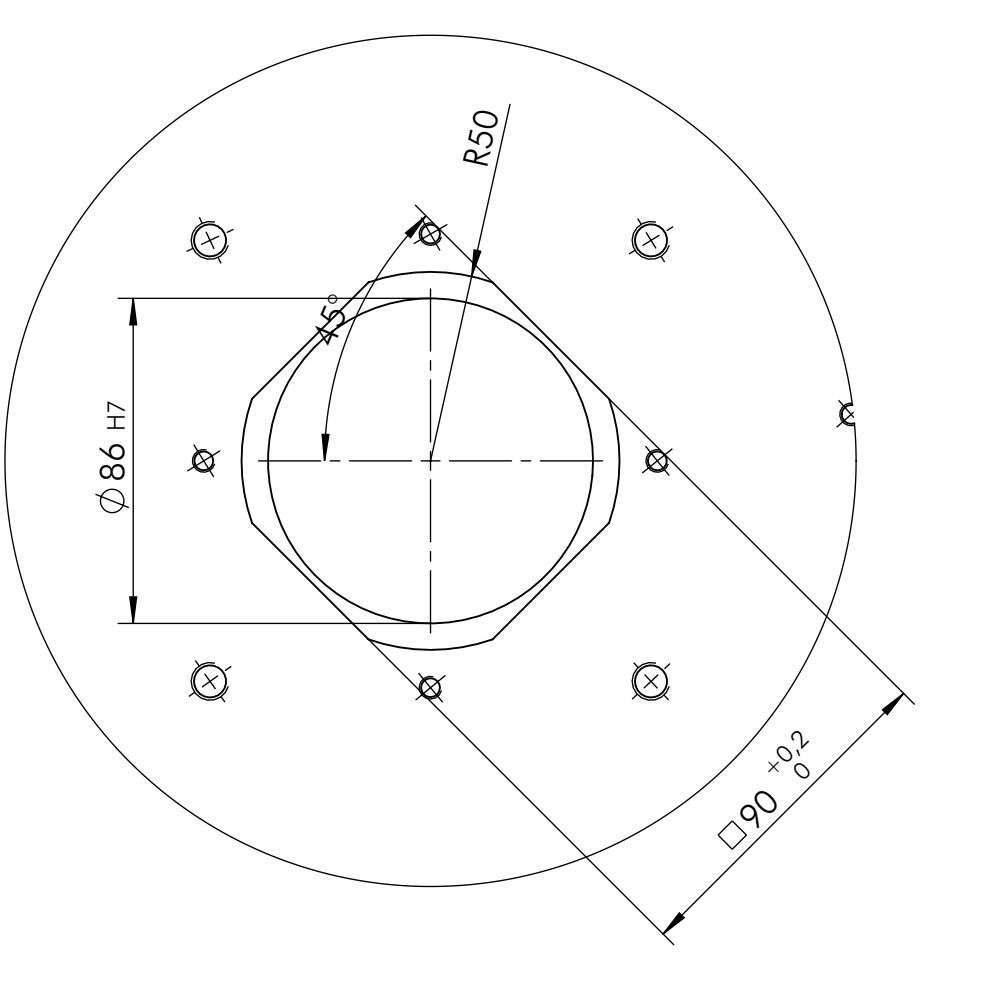

W (1 : 2)

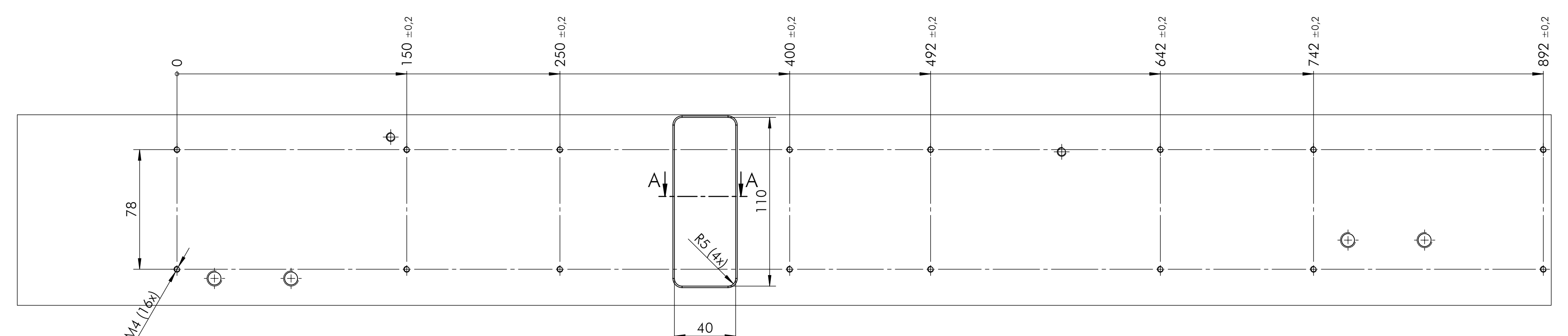

A-A (1 : 2)

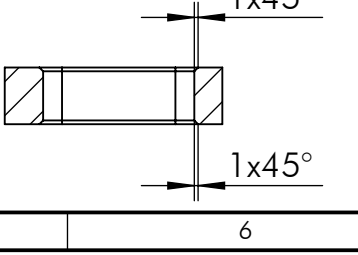

ALLE NICHT BEASSTEN FASEN 1x45°
 ALL NOT DIMENSIONED CHAMFER 1x45°
 FEHLENDE MÄÑE DEM MODELL ENTNEMHEN
 MISSING DIMENSIONS TAKE FROM MODEL
 GEWINDE, BOHRUNGEN UND PASSFLÄCHEN
 DÜRFEN AUF KEINEN FALL BESCHICHTET WERDEN
 THREADS, DRILL HOLES AND FIT SURFACES
 MUST NOT COATED ON ANY ACCOUNT
 HARTELOXIERT
 SCHICHTDÜCKE: 40µ ± 5
 FARBE: SCHWARZ
 HARD ANODIZED
 COATING THICKNESS: 40µ ± 5
 COLOR: BLACK

86 H7	+0,035
Passmass	0
Fit class	Green
abmasse	Test deviation

Stück	ALPLAN	3,3547	Werkstoff / material	AlMg4,5Mn
Surfaces according to DIN ISO 1302	Weight	KG	All undimensioned edges according to DIN ISO 13715	10.3 10.3
General tolerance according to ISO 2768-mK	Scale	1:5		10.3 10.3
AD Date Name Scale Color:				
Created 28.10.2022 YAM,PA				
Revised 13.03.2023 INCL, W				
Drawn 28.10.2022 YAM,PA				
Drawing No.	27.002.0522.0000			
Description	BASE PLATE			
	GRUNPLATTE			
Replaced by	Ceprift am 16.03.2023 von DPK-BATCH...			