

1600 x 900 = 1440 m
1000 = 0,5 m
Rura = 100 cm

Kanale w RTR

Końcowa plania p.d.c. stawy
p.r.e.s.c.u.p.h.v.
w e.t.e.k.y p.r.e.s.c.u.p.h.v. z 160 m

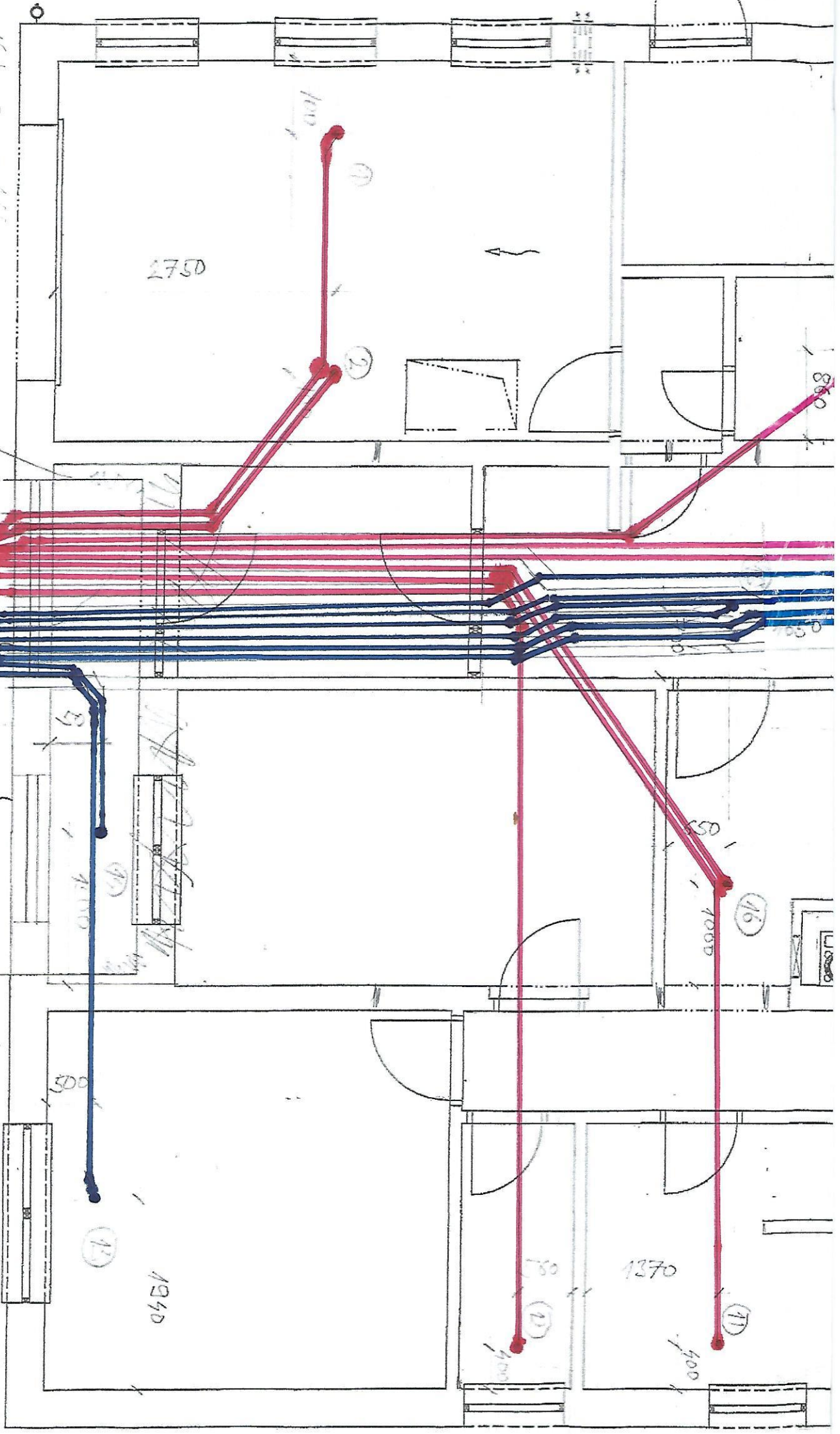

2750

116

117

115

1340

1370

1000

1050

1000

1050

900

800

850

850

800

