

# PŘÍRUČKA K INSTALACI

1. Našroubujte podpěrné tyče do držáků.

Upozornění: Nepoužívejte jakýkoliv korodující roztok k vyčištění hliníkových a ostatních kovových částí při denní údržbě.

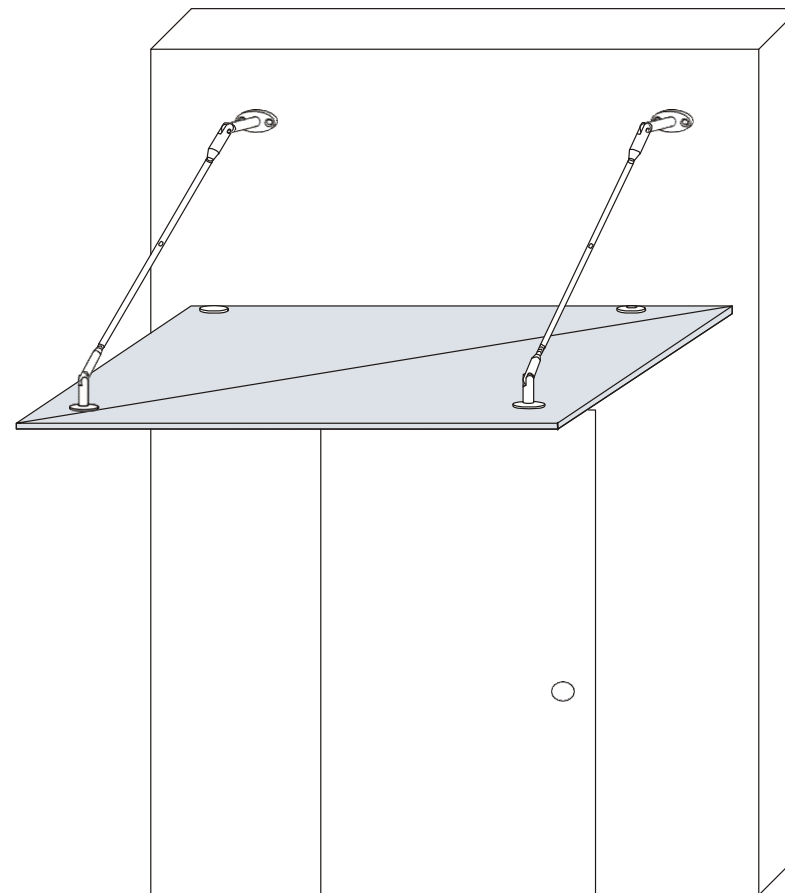
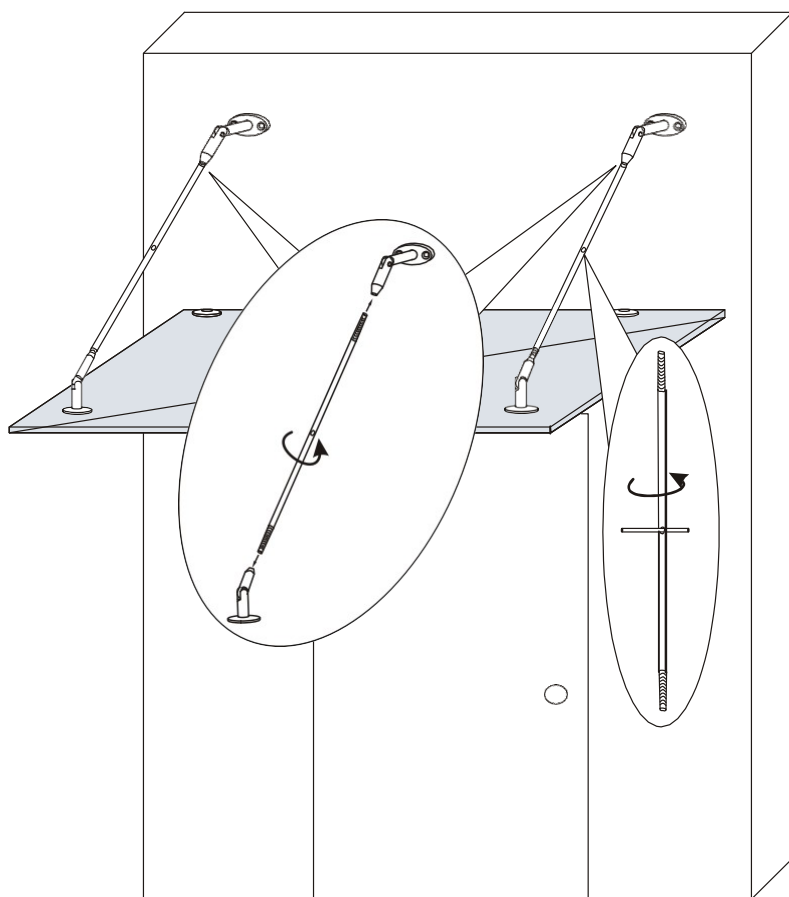
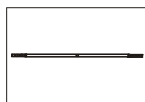

TP-001

RoHS  ISO9001:2000

## Potřebné nástroje

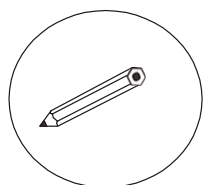

Tužka

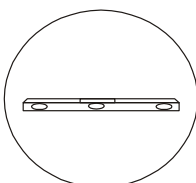

Vodováha

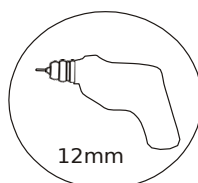

Vrtačka  
12mm

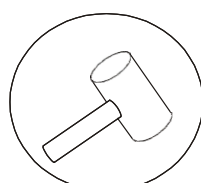

Gumová palička

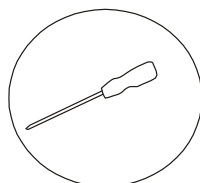

Křížový šroubovák

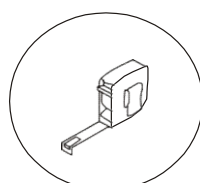

Metr

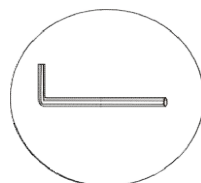

Inbus (v balení)

## Obsah balení

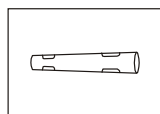

PJ-4044

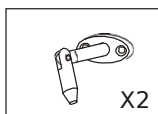

PJ-4014  
X2

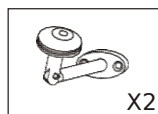

PJ-4015  
X2

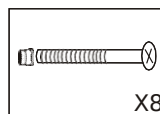

PJ-4024  
X8

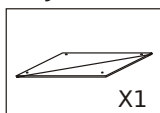

Sklo  
X1



PJ-4013  
X2

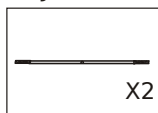

LG-2007  
X2

1. Připevněte sklo ke spodním držákům a utáhněte inbusem

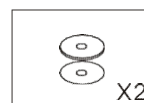

X2

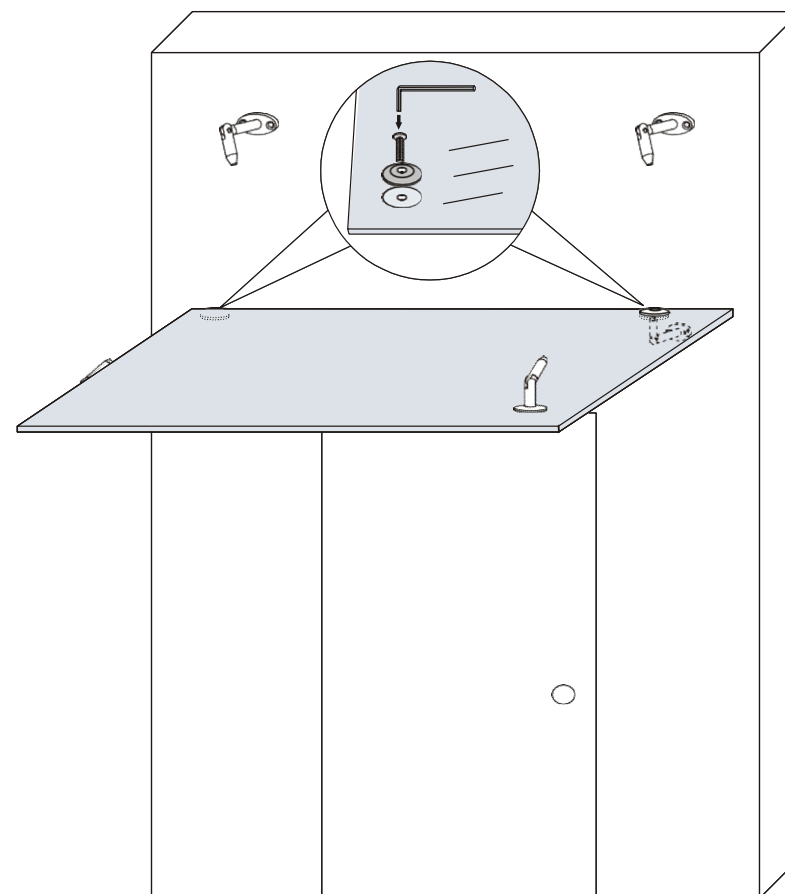
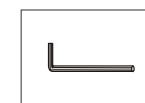
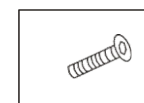
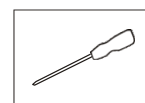

1. Namontujte držáky na sklo a utáhněte pomocí inbusu

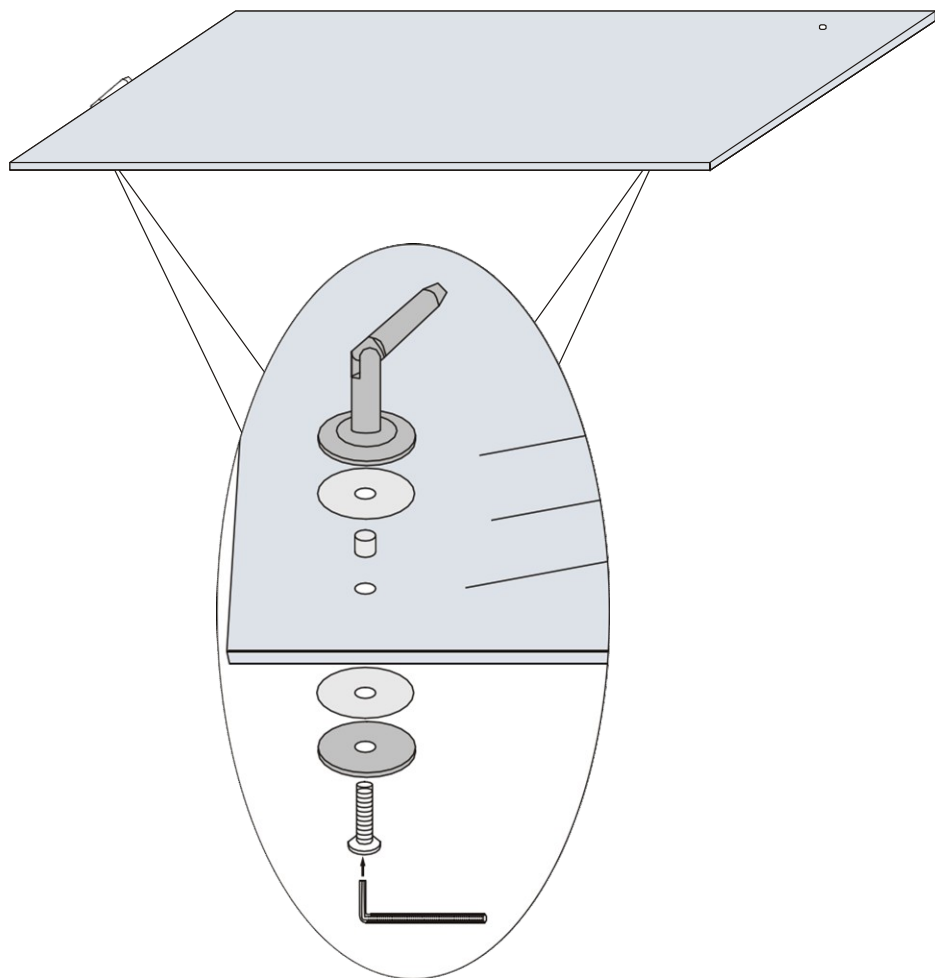
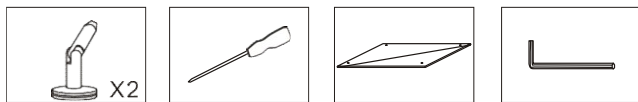

4

1. Označte si tužkou body podle obrázku, využijte metr pro změření vzdálenosti, následně si zjistěte rovinu vodováhou.

Délka skla	A	B
1200mm	1020mm	550mm
1500mm	1320mm	550mm
1800mm	1620mm	550mm
2000mm	1600mm	550mm

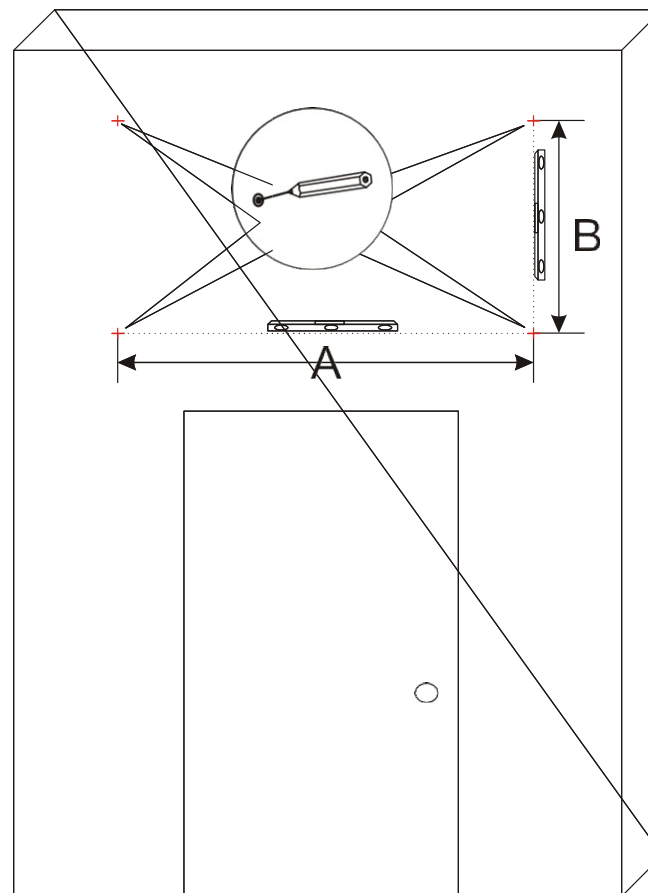
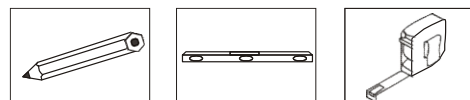

1

1. Udělejte si 2 body do 4 stanovených bodů (celkem 8), C = 2,5 cm
2. Vyrtejte díry do stanovených bodů

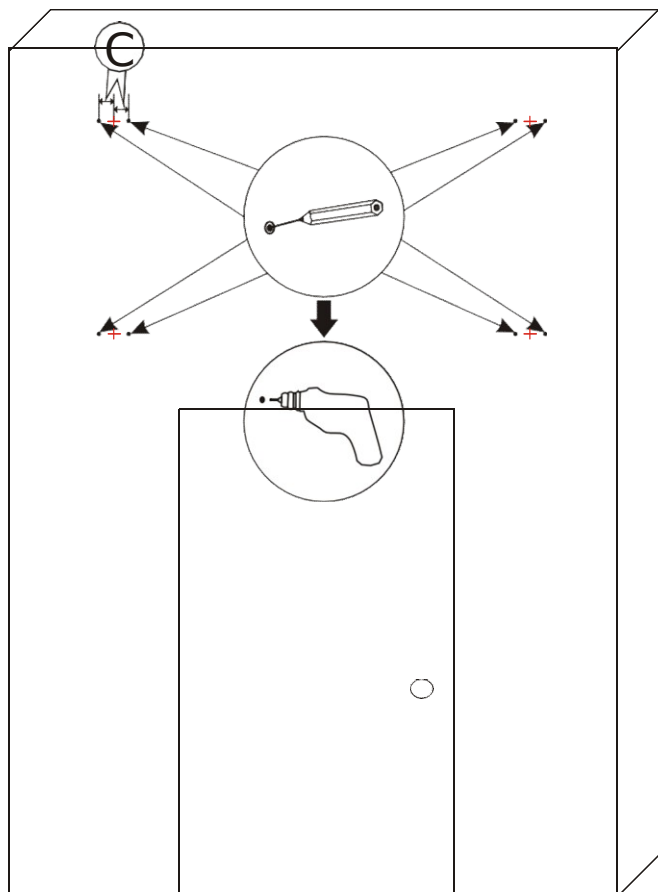
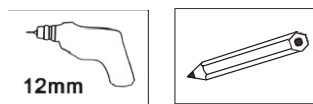

2

1. Namontujte držáky a utáhněte šrouby pro zajištění

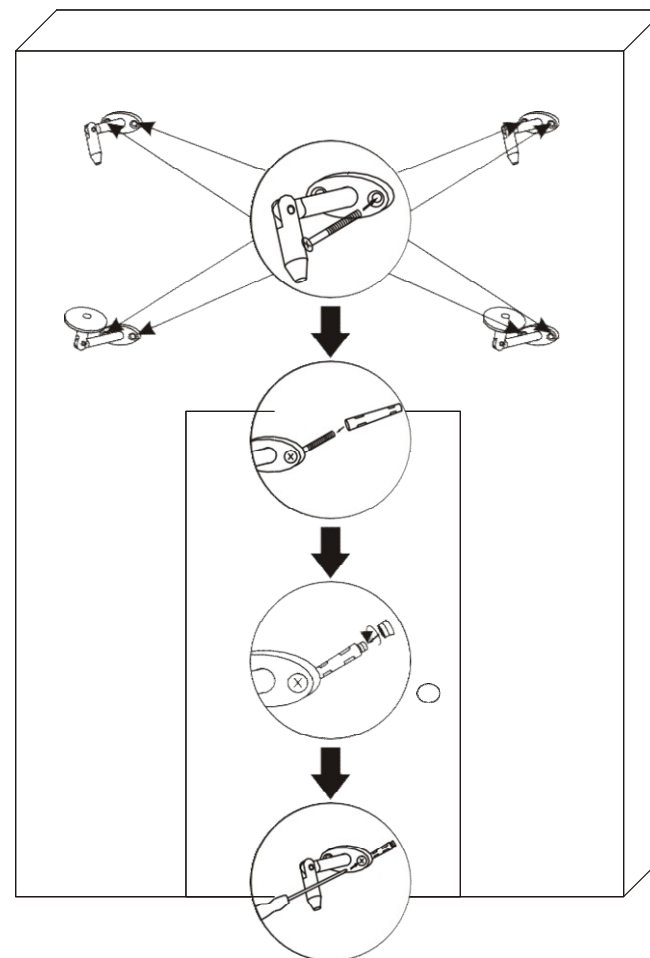
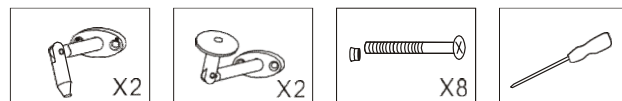

3