

Úroveň

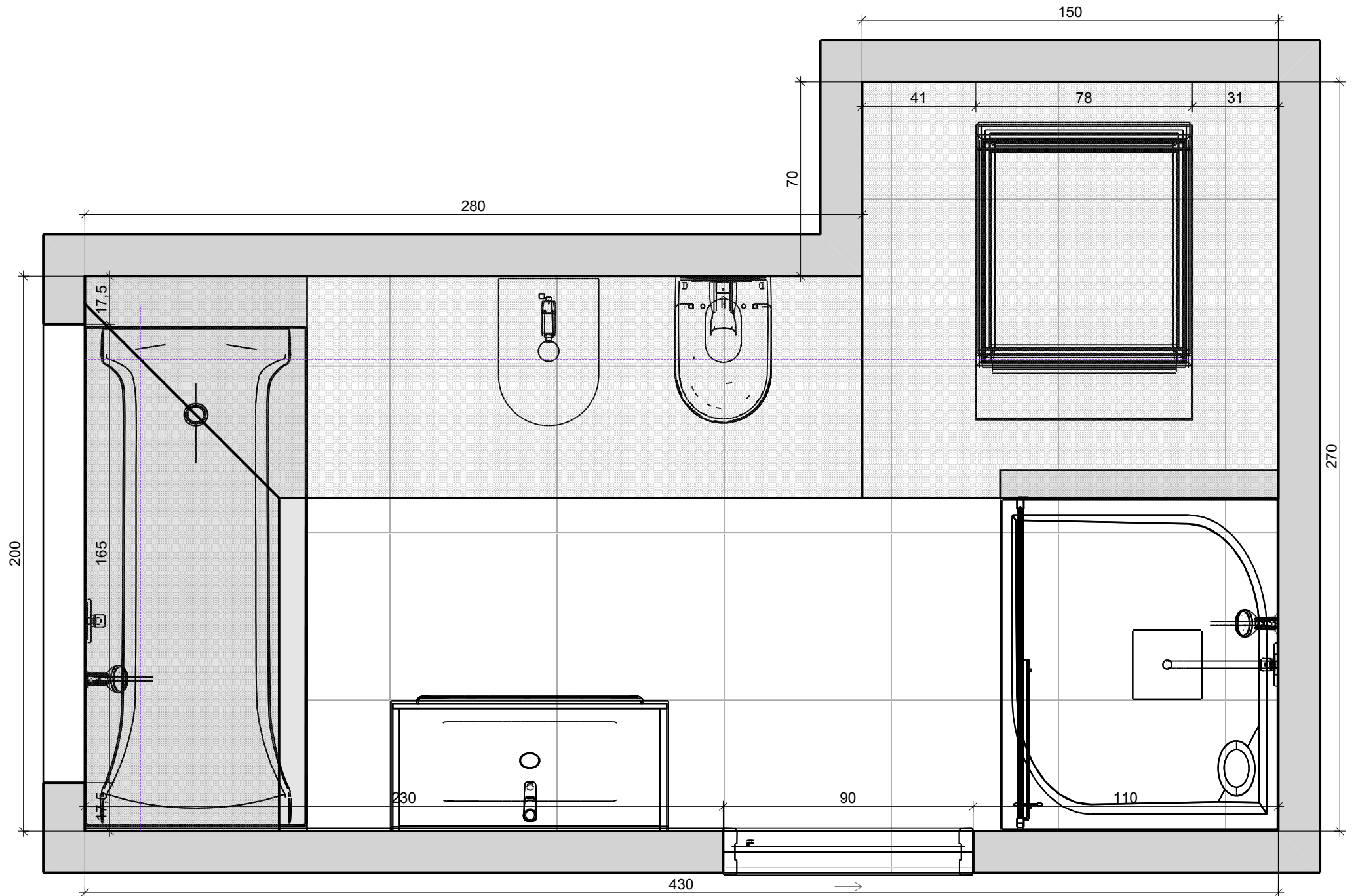

Informace o prostoru

Informace o prostoru

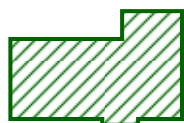

Základní plocha	9,79 m ²
Obvod	14,00 m
Objem	21,05 m ³
Výška	2,50 m

Podlaha



Celková plocha	8,09 m ²	
Obvod	14,91 m	
Obložená plocha	100%	8,09 m ²

Stěny a zdi

Celková plocha	31,41 m ²	
Obložená plocha	98%	30,62 m ²
Plocha s texturou	2%	0,78 m ²

Strop

Celková plocha	4,32 m ²
----------------	---------------------

Střecha

Plocha zkosené střechy	6,62 m ²
------------------------	---------------------

Místnost

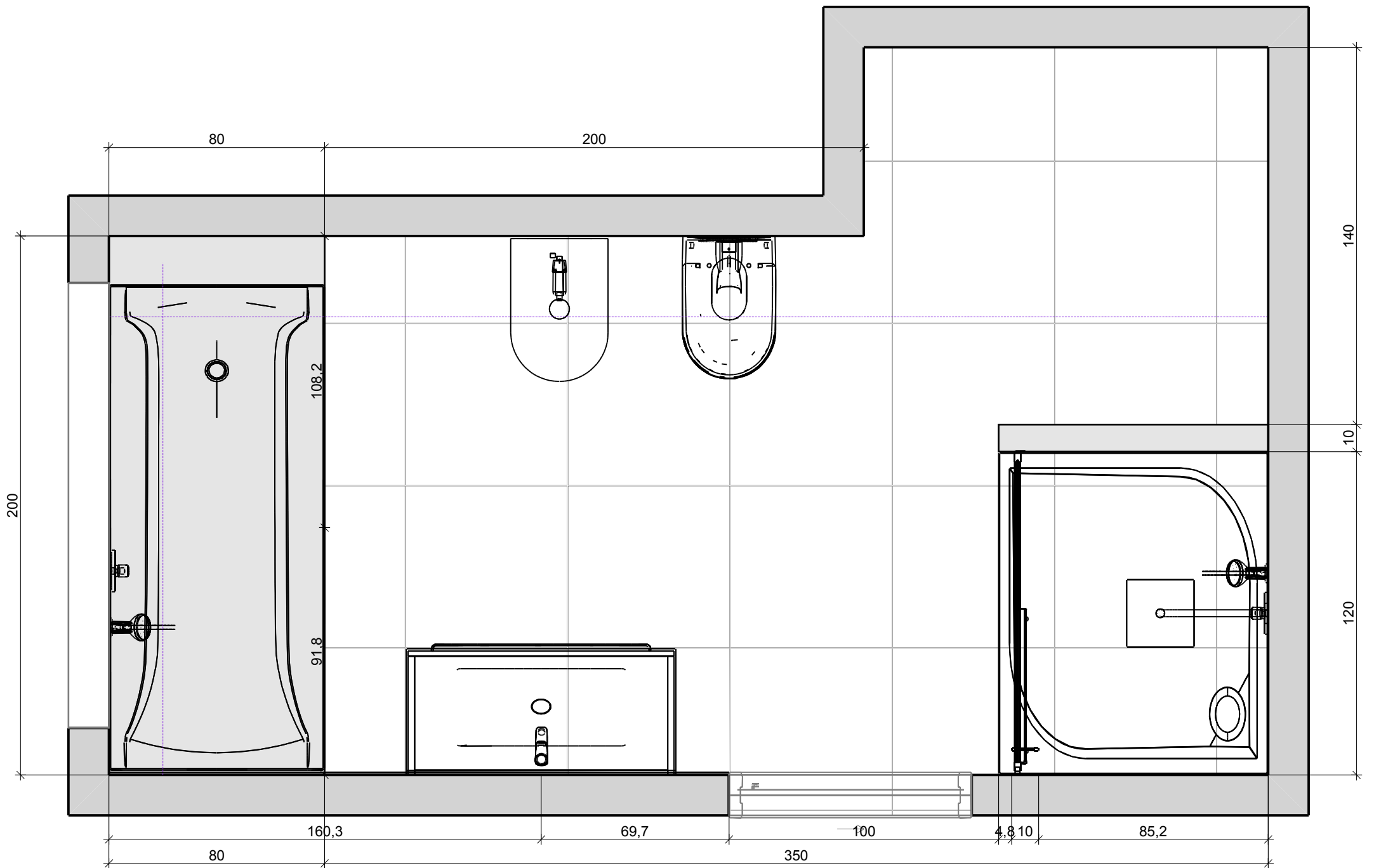

Řez A - A

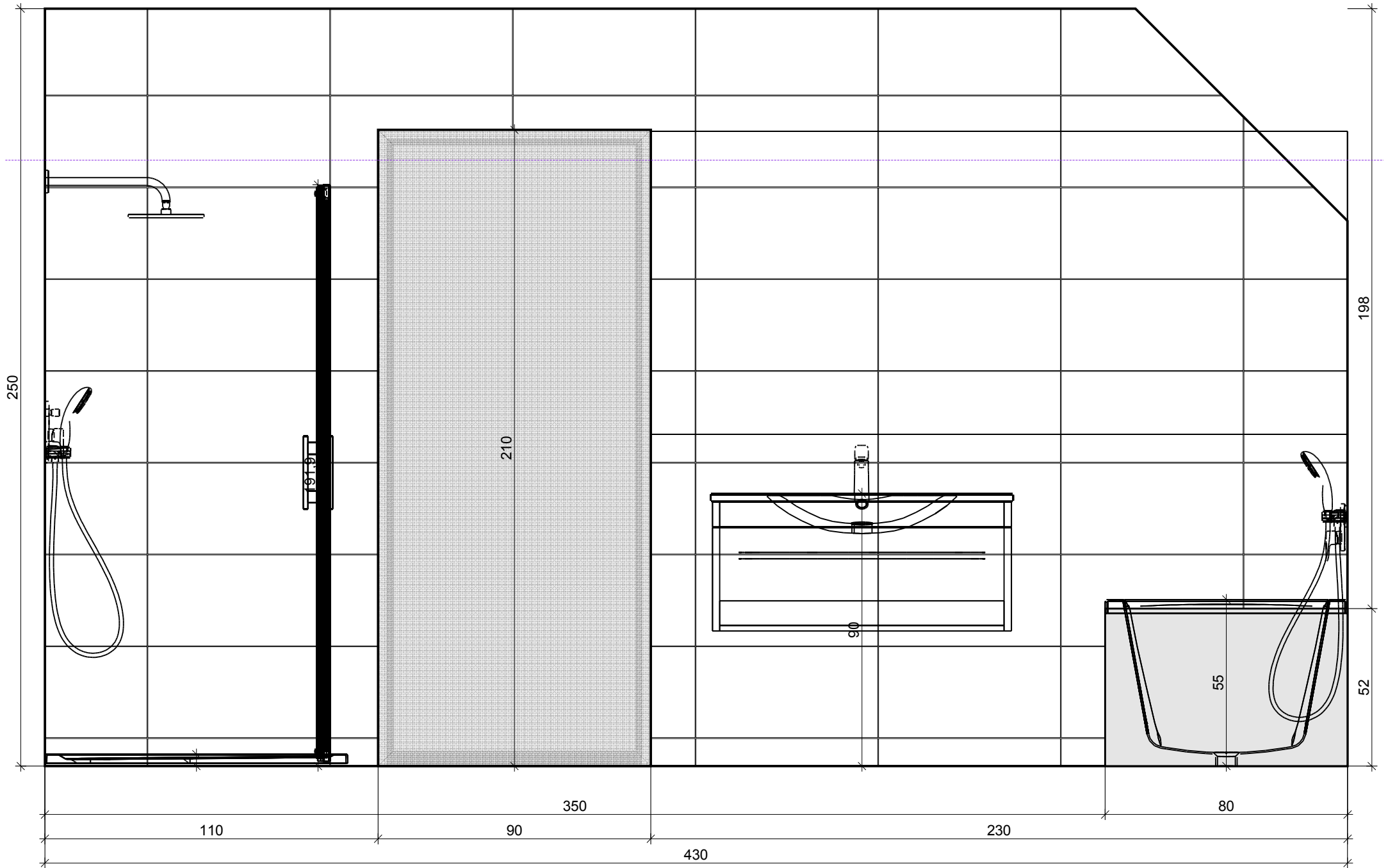

Řez B - B

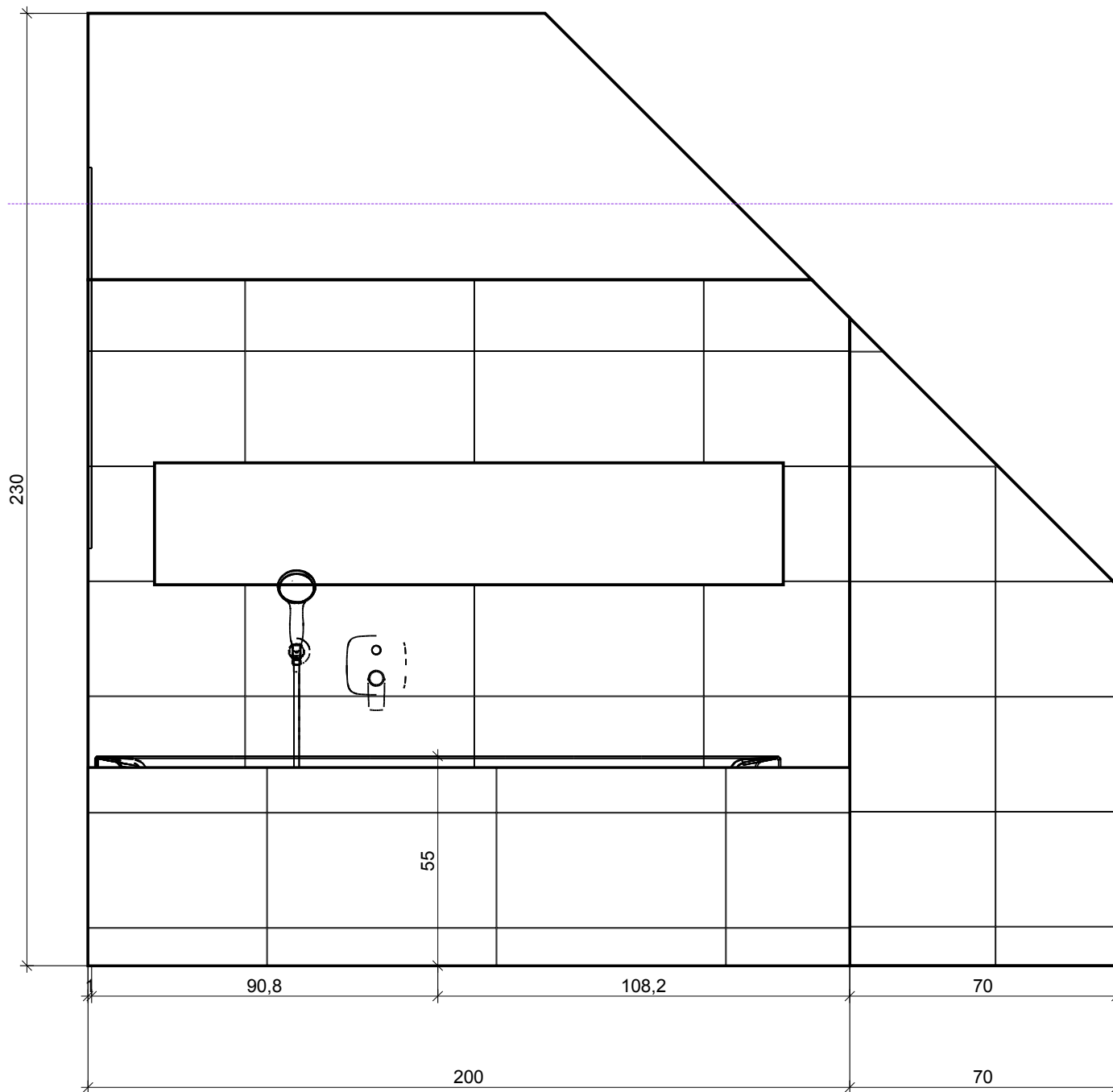

Řez C - C

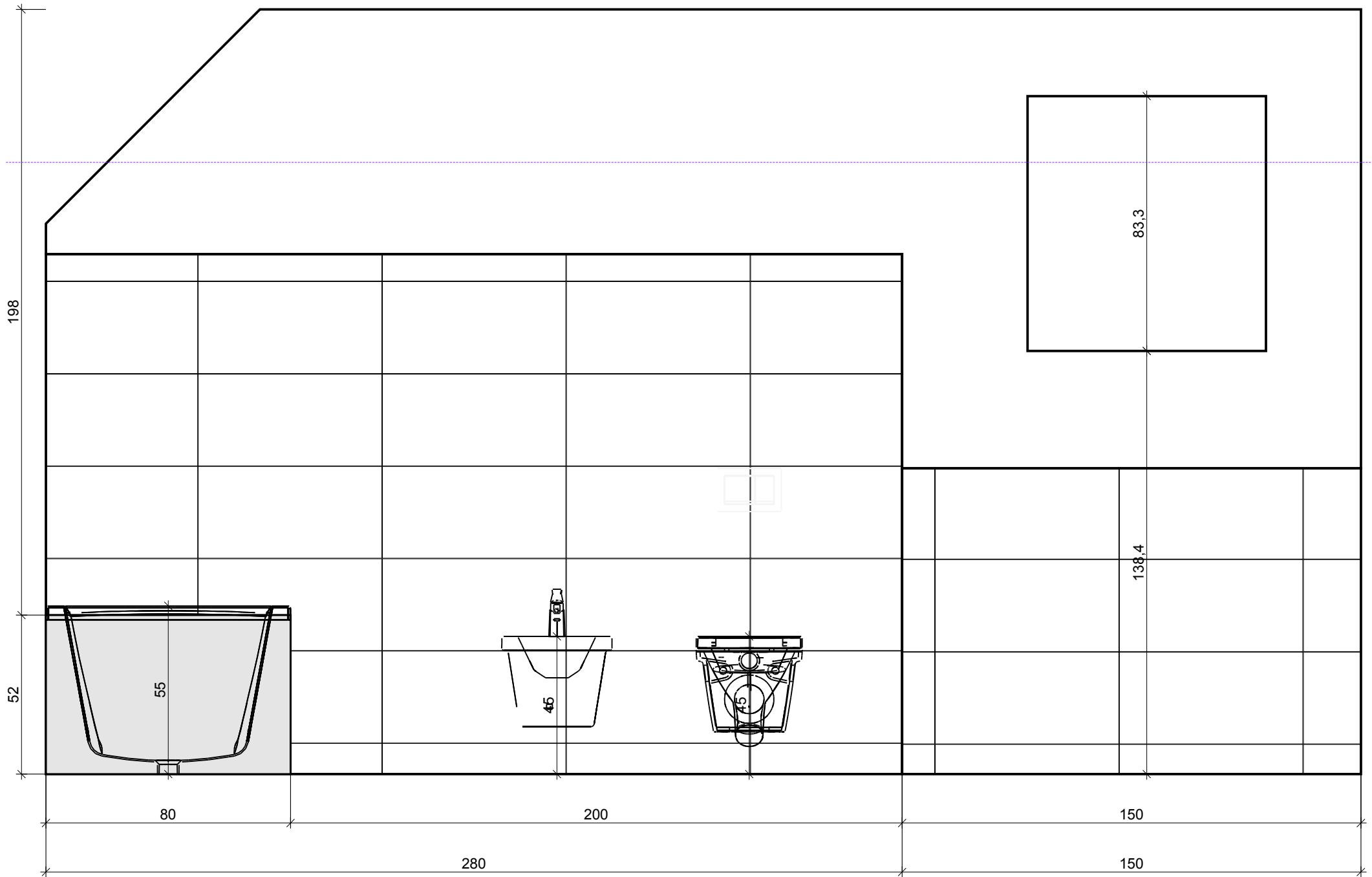

Řez D - D

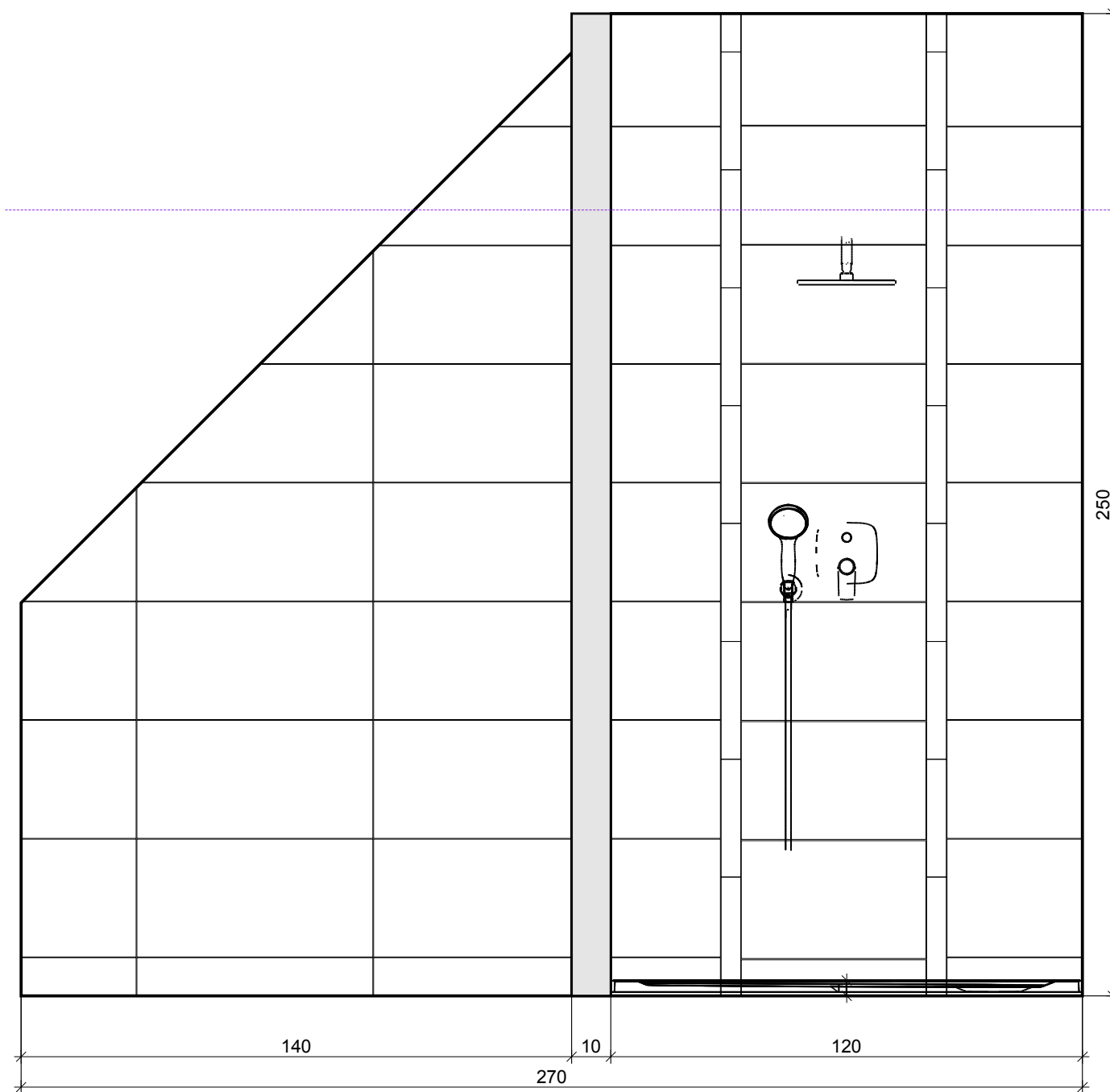

Podlaha

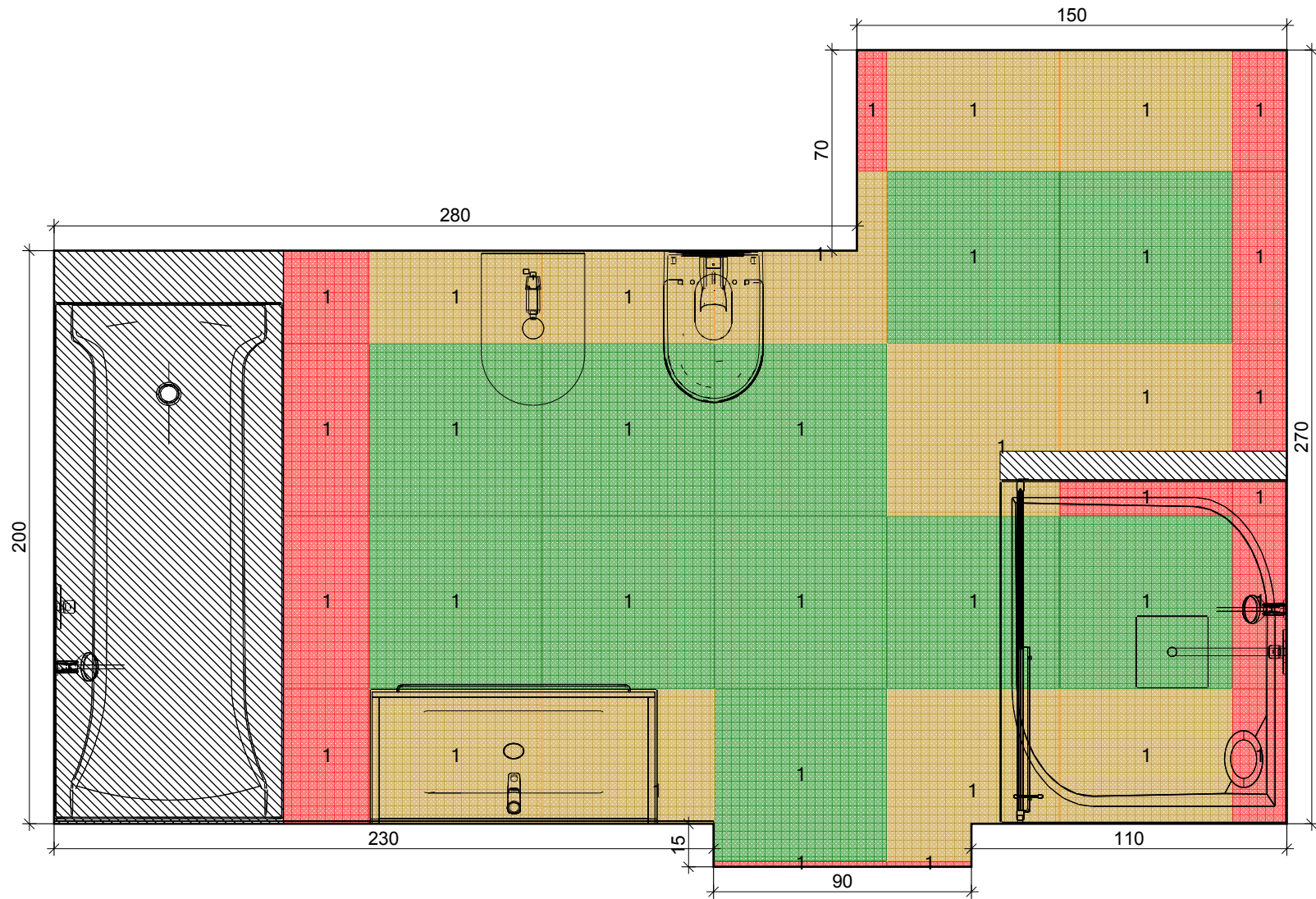

1

Marazzi



M0VJ
600 x 600

Stěna 1

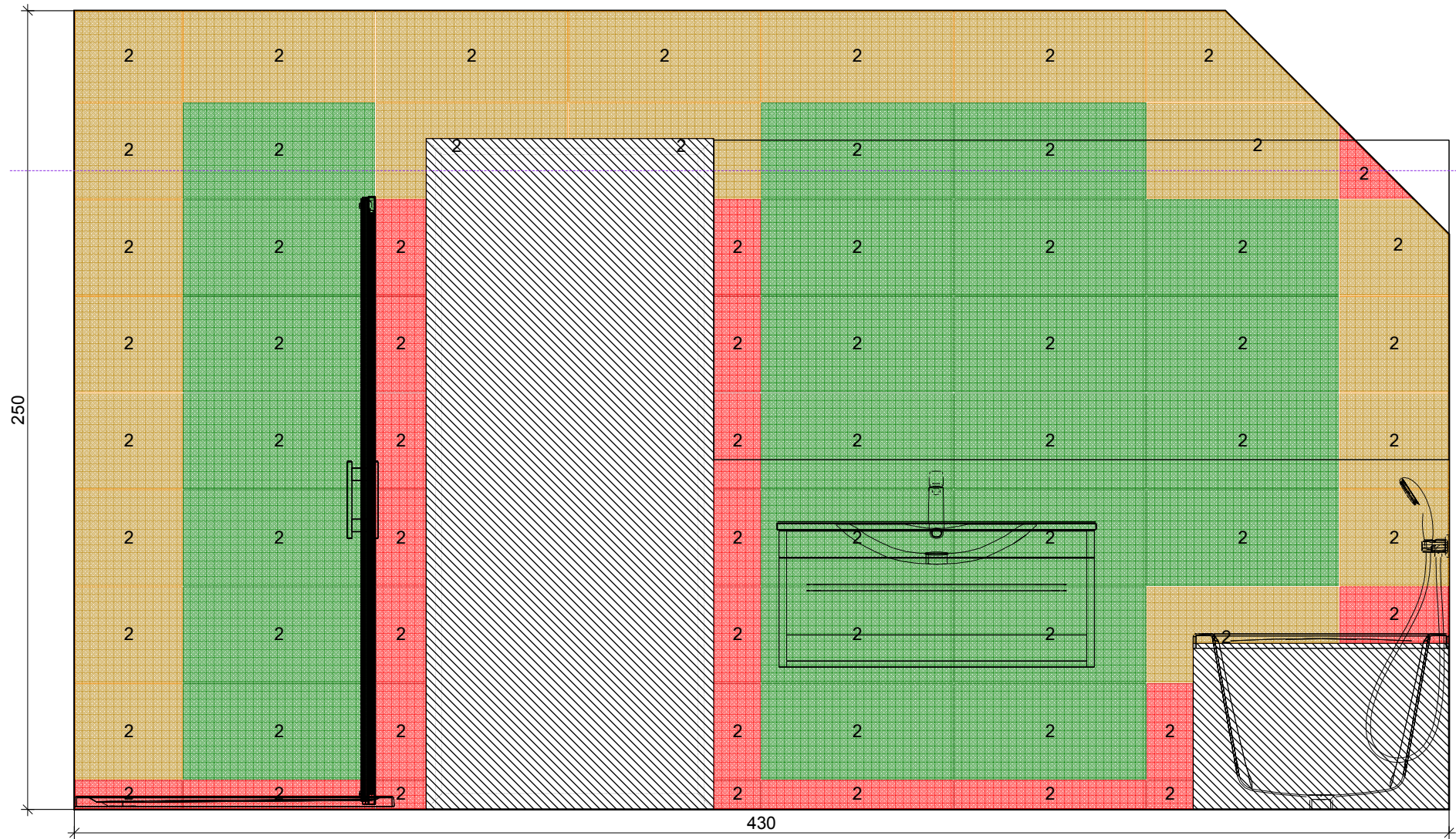

2

Marazzi

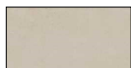

MOWG
600 x 300

Projekt:	Bůžková - koupelna II
Datum: 30.4.2019	Strana 9

Stěna 2

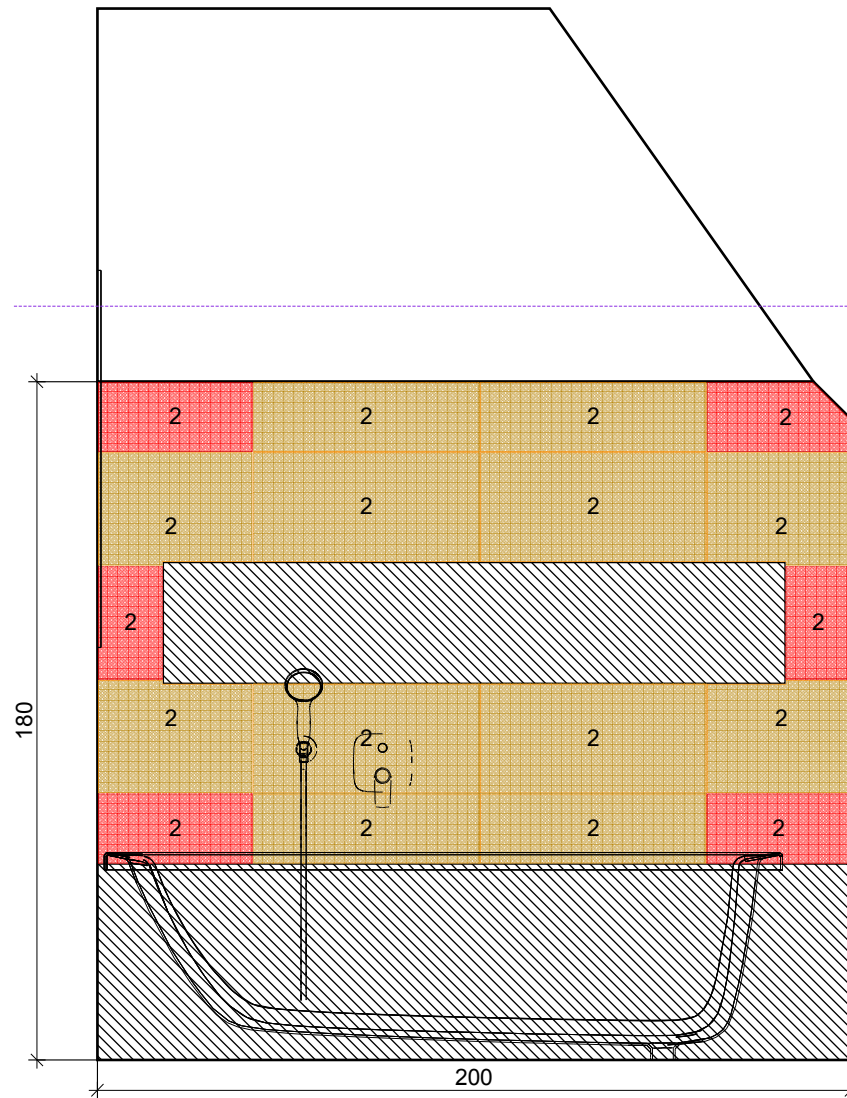

2

Marazzi



MOWG
600 x 300

Stěna 3

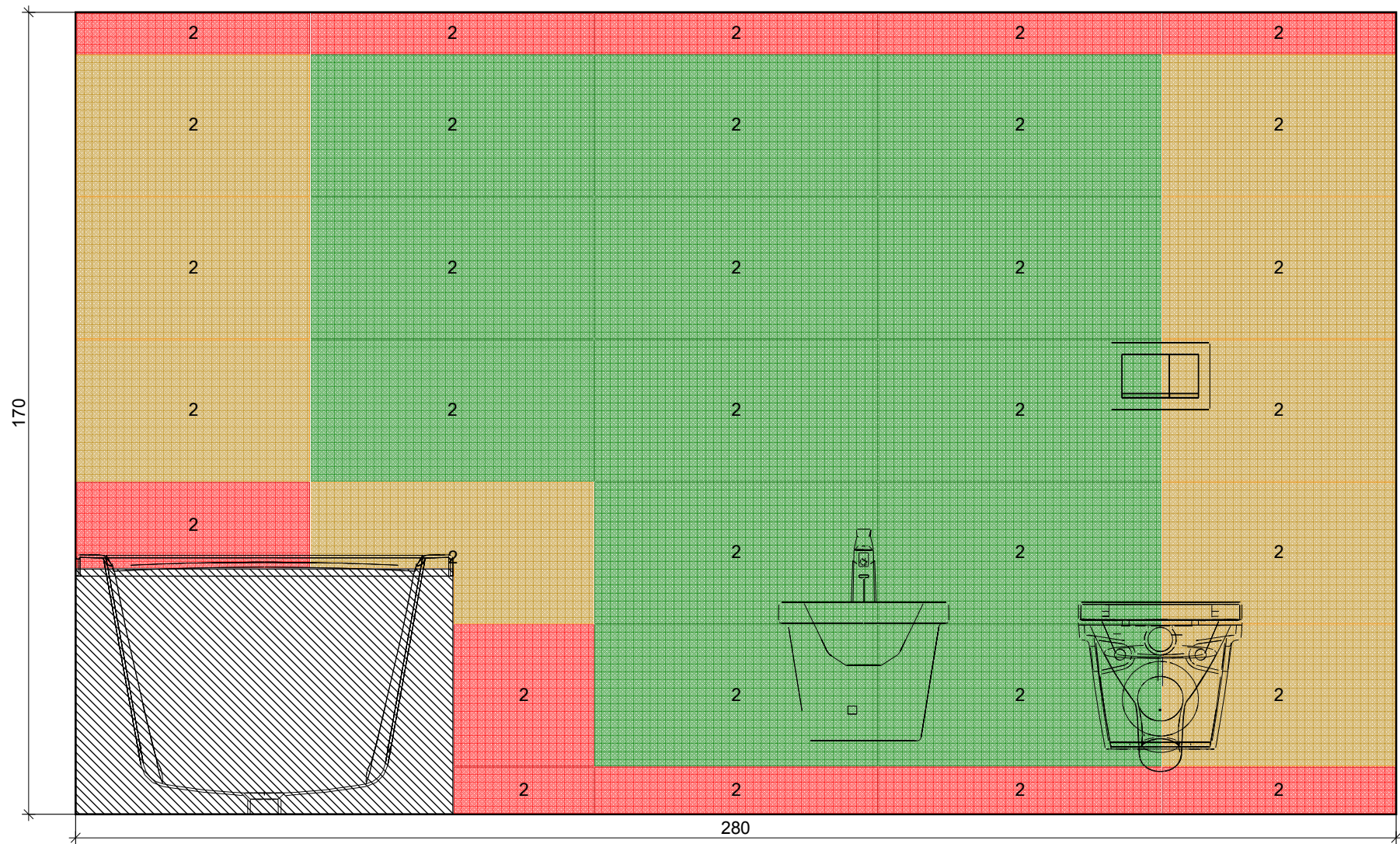

2

Marazzi



MOWG
600 x 300

Stěna 4

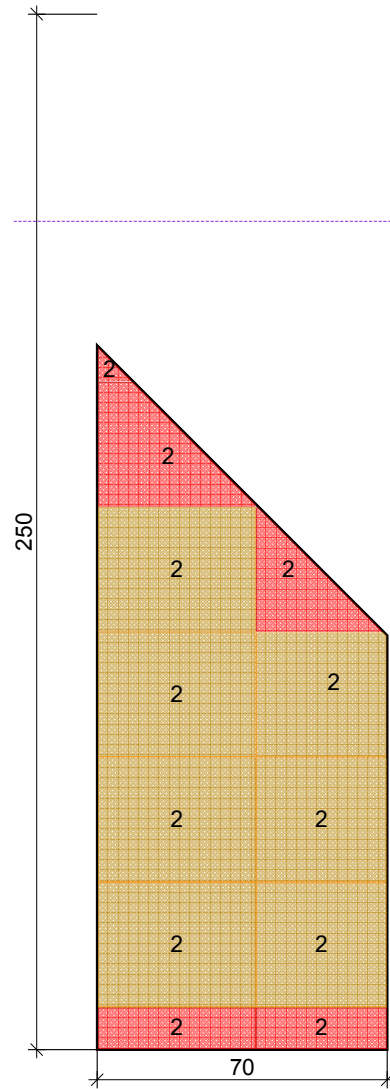

2

Marazzi



MOWG
600 x 300

Stěna 5

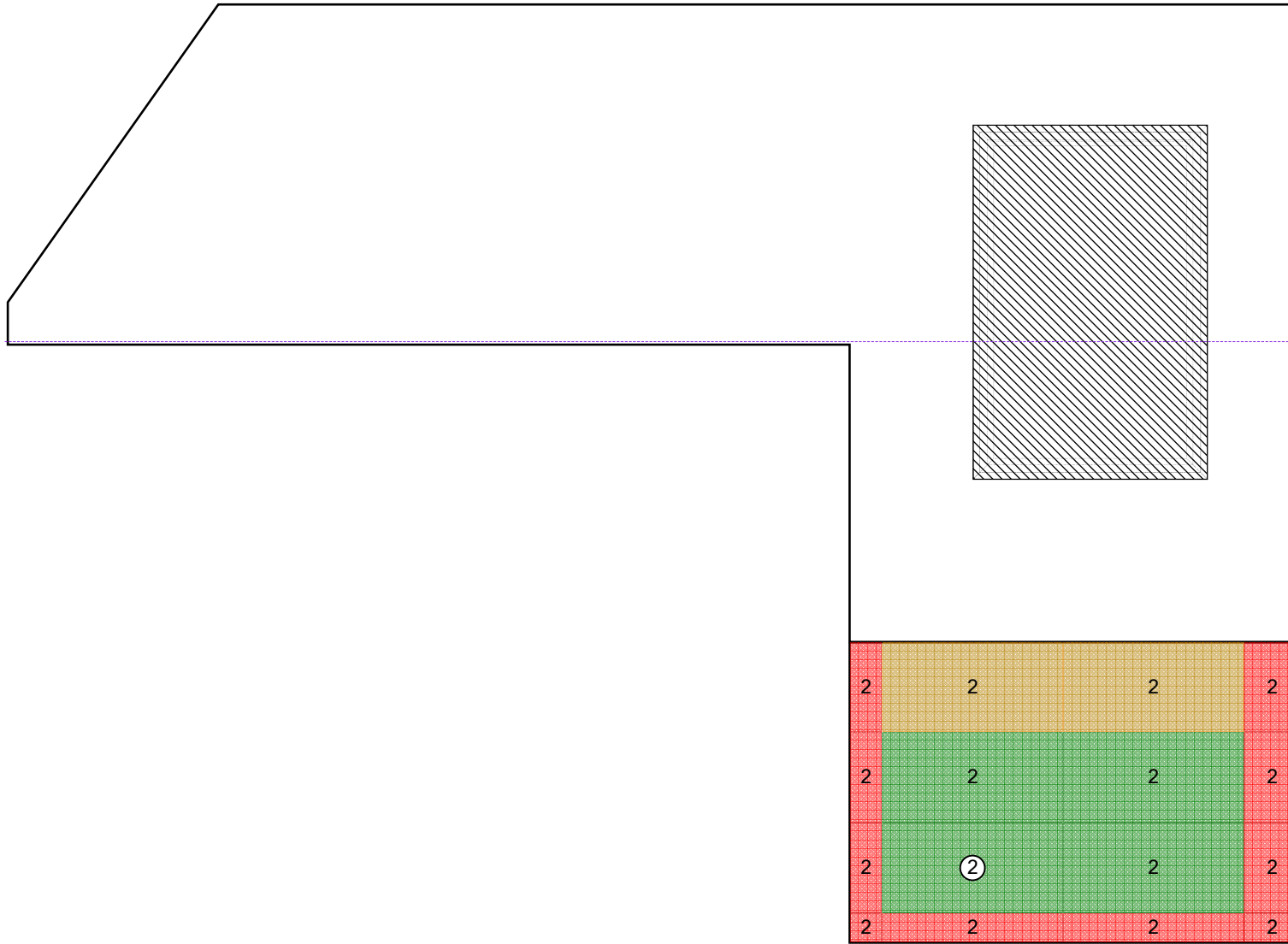

2

Marazzi



MOWG
600 x 300

Stěna 6



2

Marazzi



MOWG
600 x 300

3

Naxos

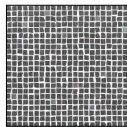

75113
300 x 300

Zed' 2

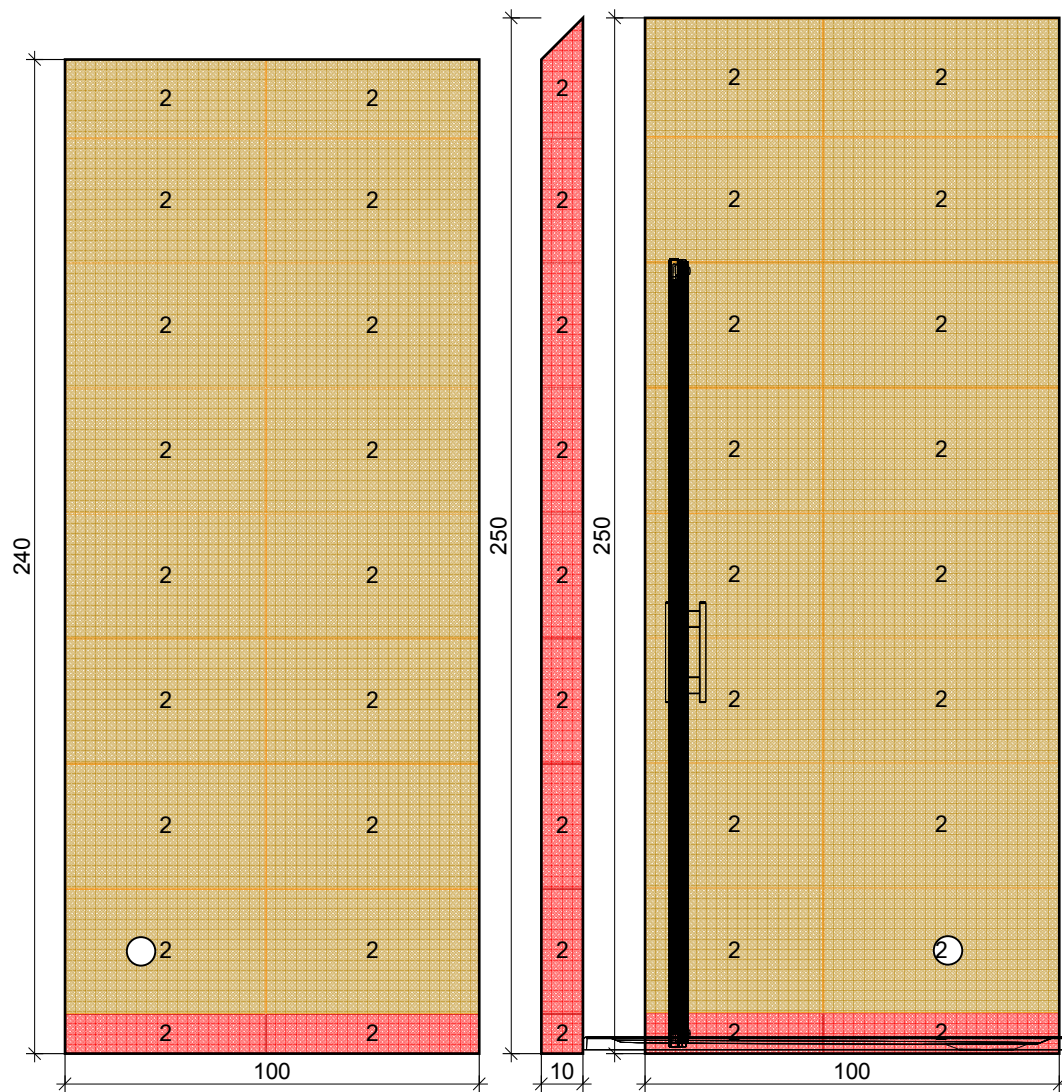

2

Marazzi

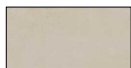

MOWG
600 x 300

Zed' 3

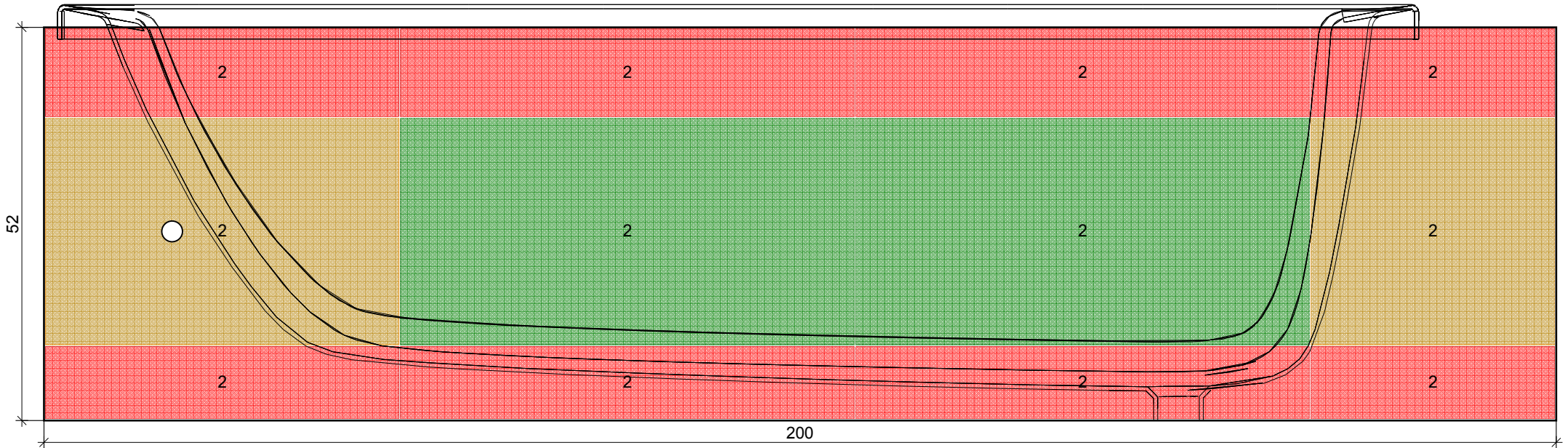

2

Marazzi



MOWG
600 x 300

Zed' 3 / Zed' nahore

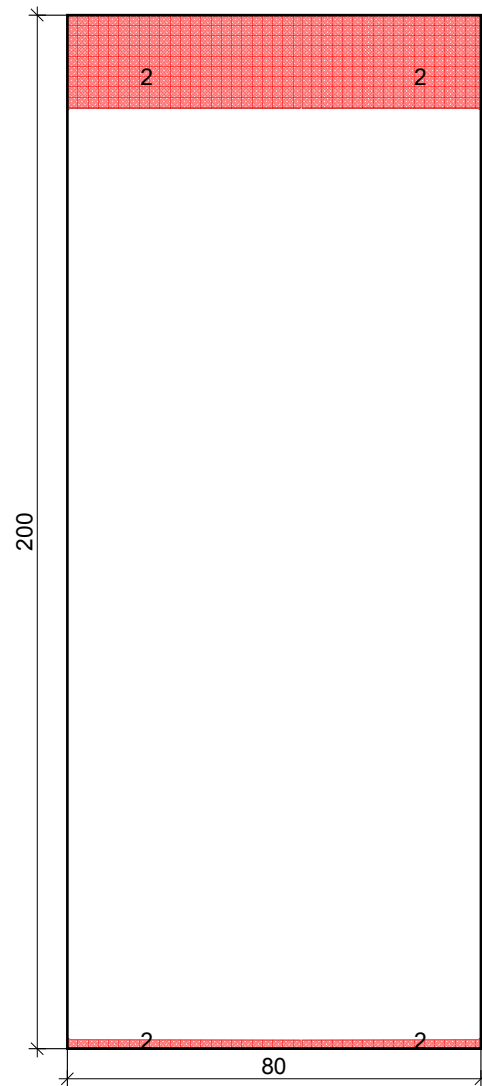

2

Marazzi

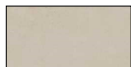

MOWG
600 x 300