

Rev	Rev art / Revisionsmeddelande	Godkänd av - datum

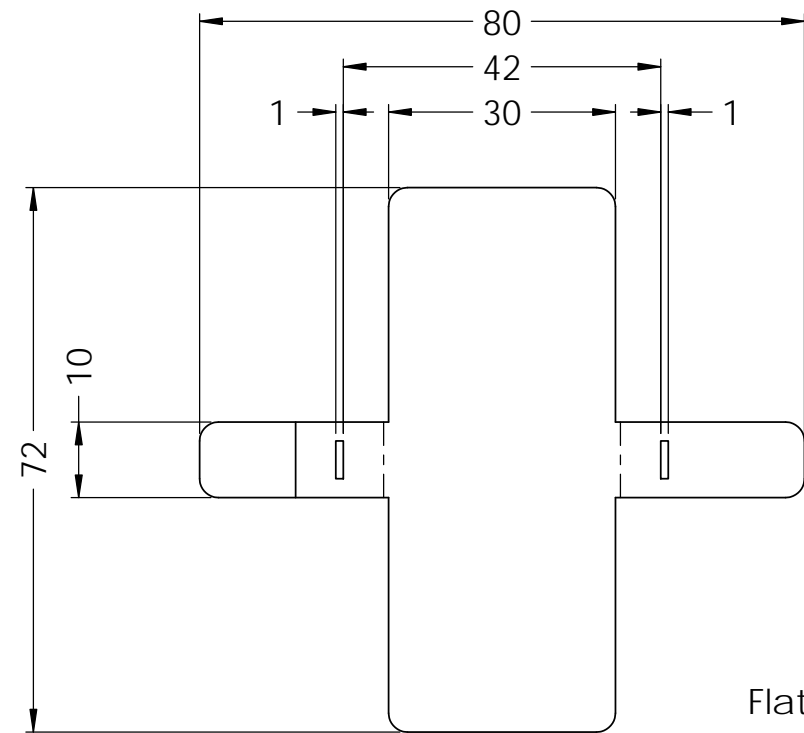
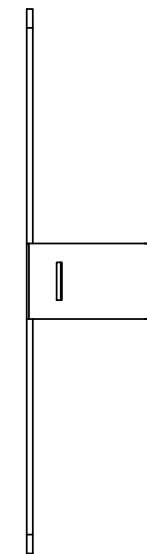
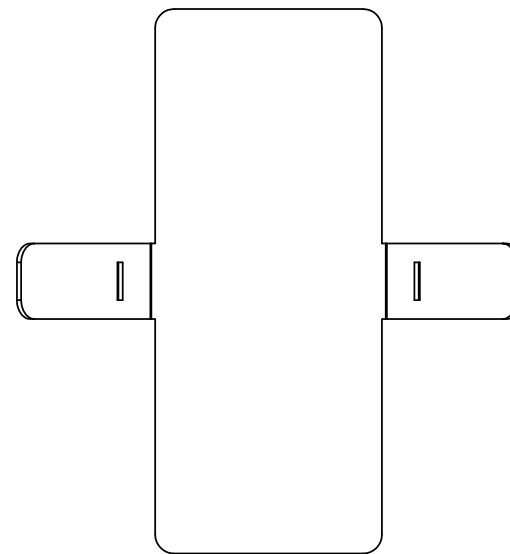
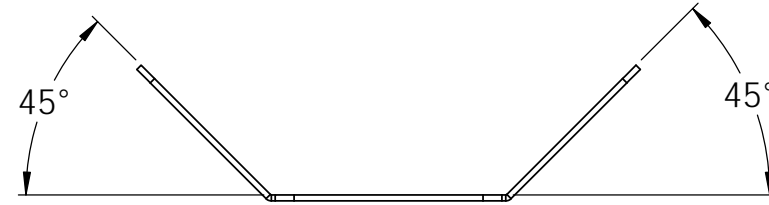

Flat

Material Steel sheet EN-430 tj = 0,8

Ytbehandling 1

Ytbehandling 2

Ytbehandling 3

Dokumenttyp		Godkänd av - datum		Tolerans (om ej annat anges)		Vyplacering		Skala (A3)	
Ritad av - Datum N. Hakala 2014-03-21				ISO 2768 - 1 -m				1:2	
Företag			Titel/benämning Corner part Star Stove						
			Artikelnummer				Rev	Sida	
							1	1 (1)	