

BB'

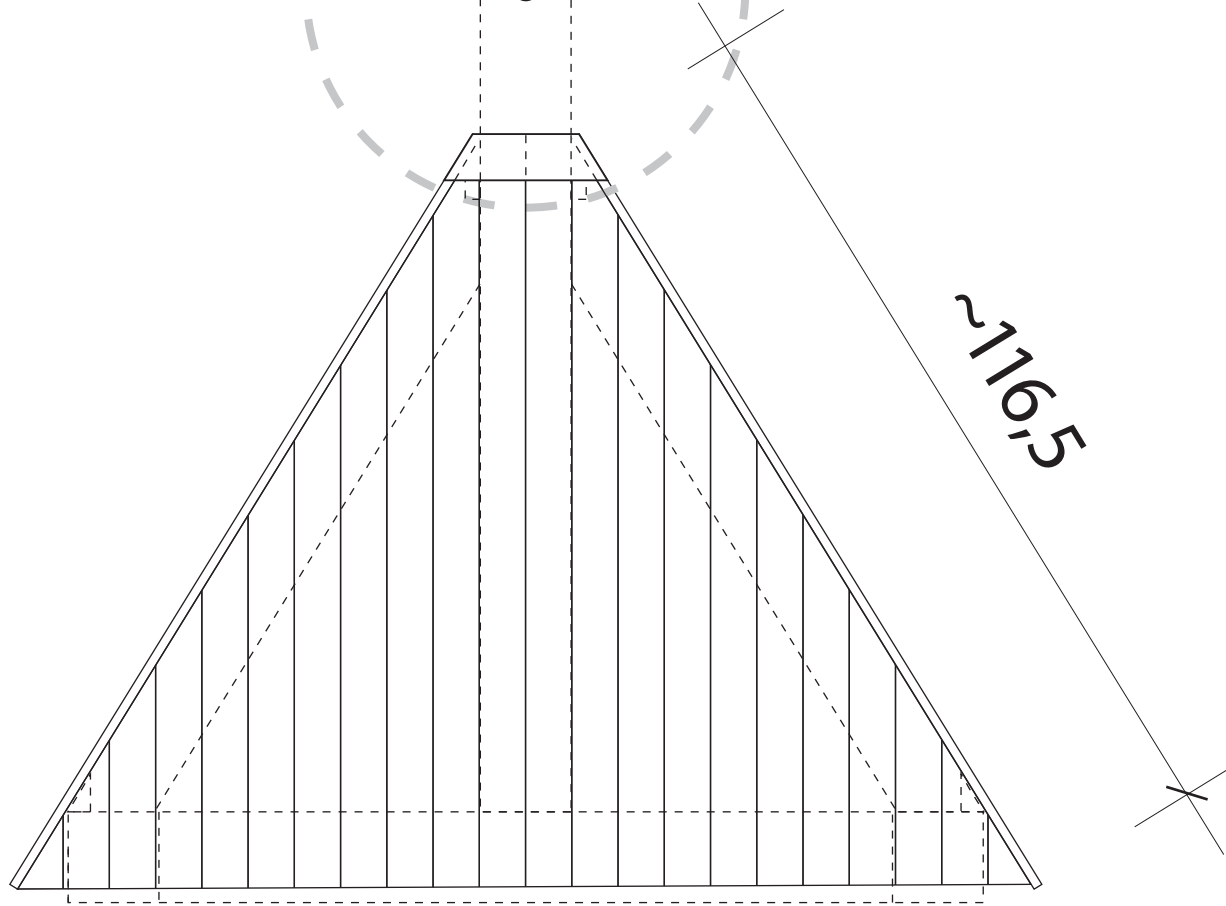

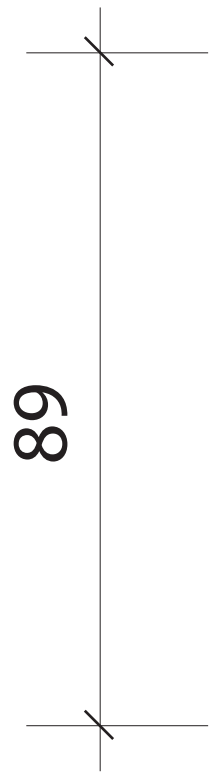
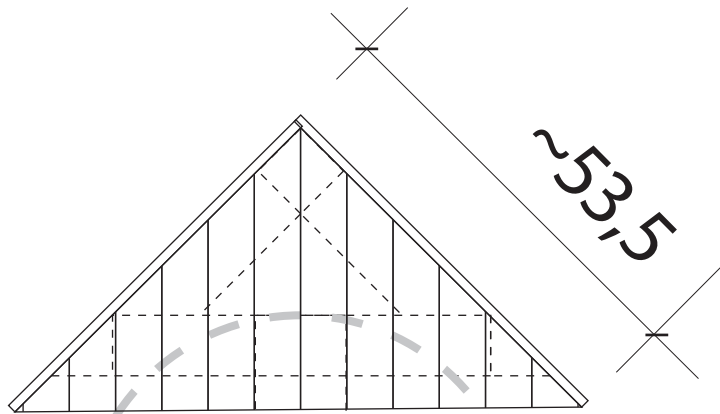
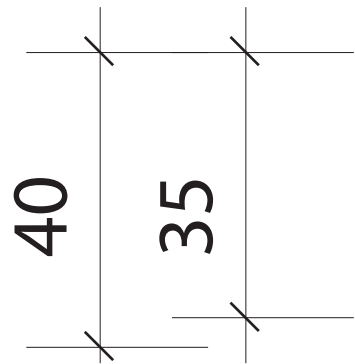
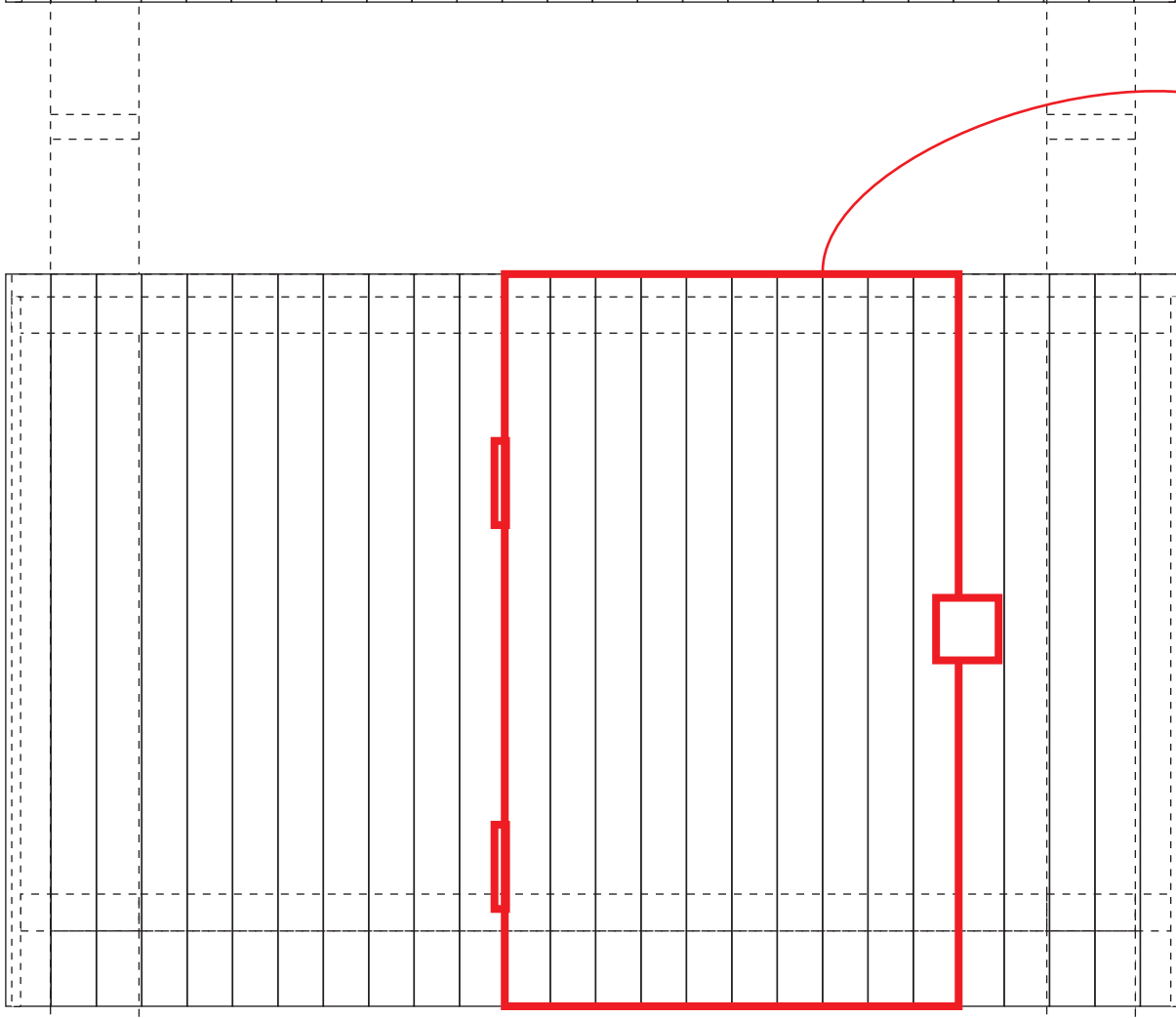
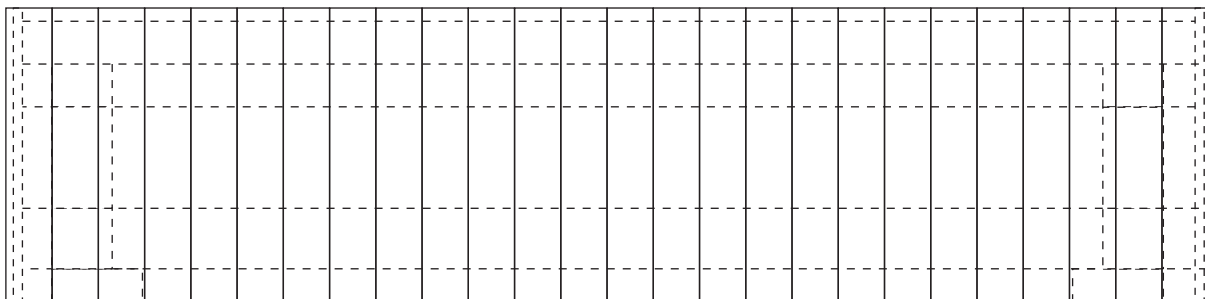

v pobití jsou
„skrytá“ dvířka

121

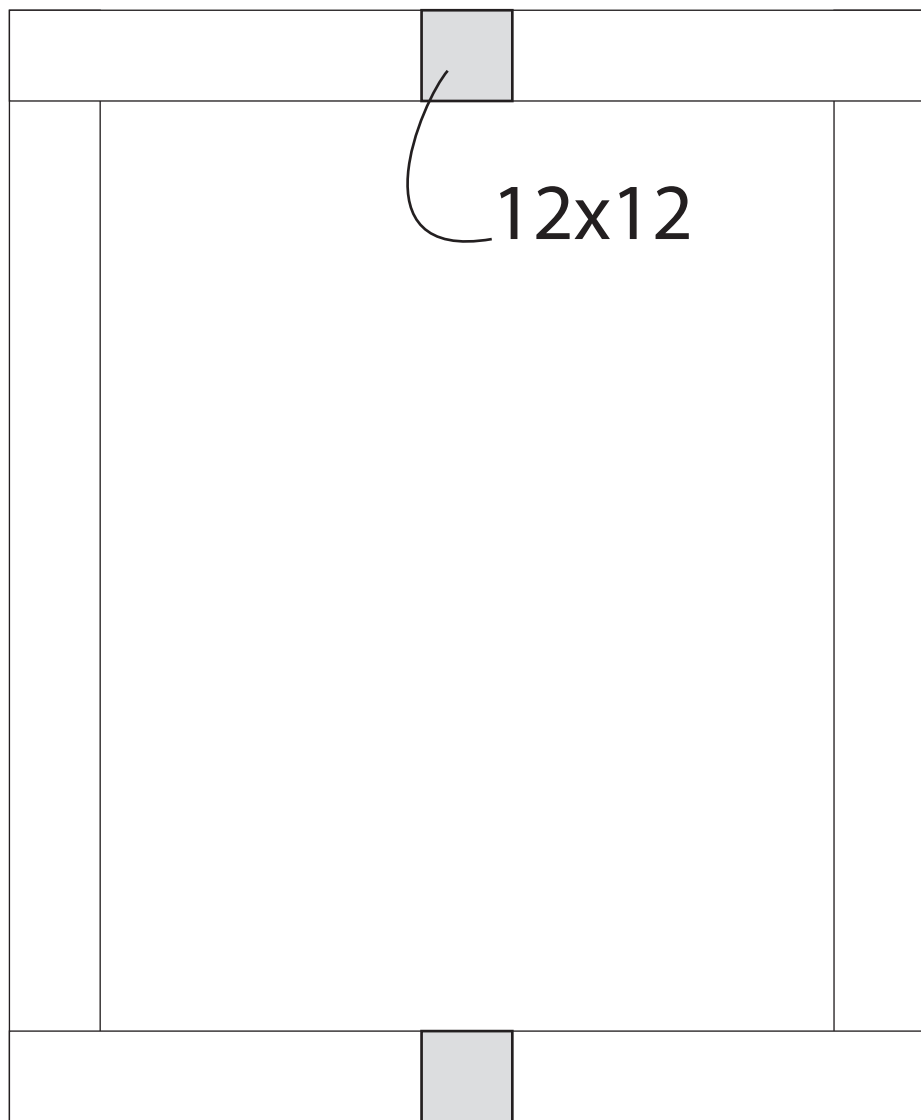

12x12

147

spodní rám a sloupky

přesahy cca 6 cm
(podle šířky pobití)

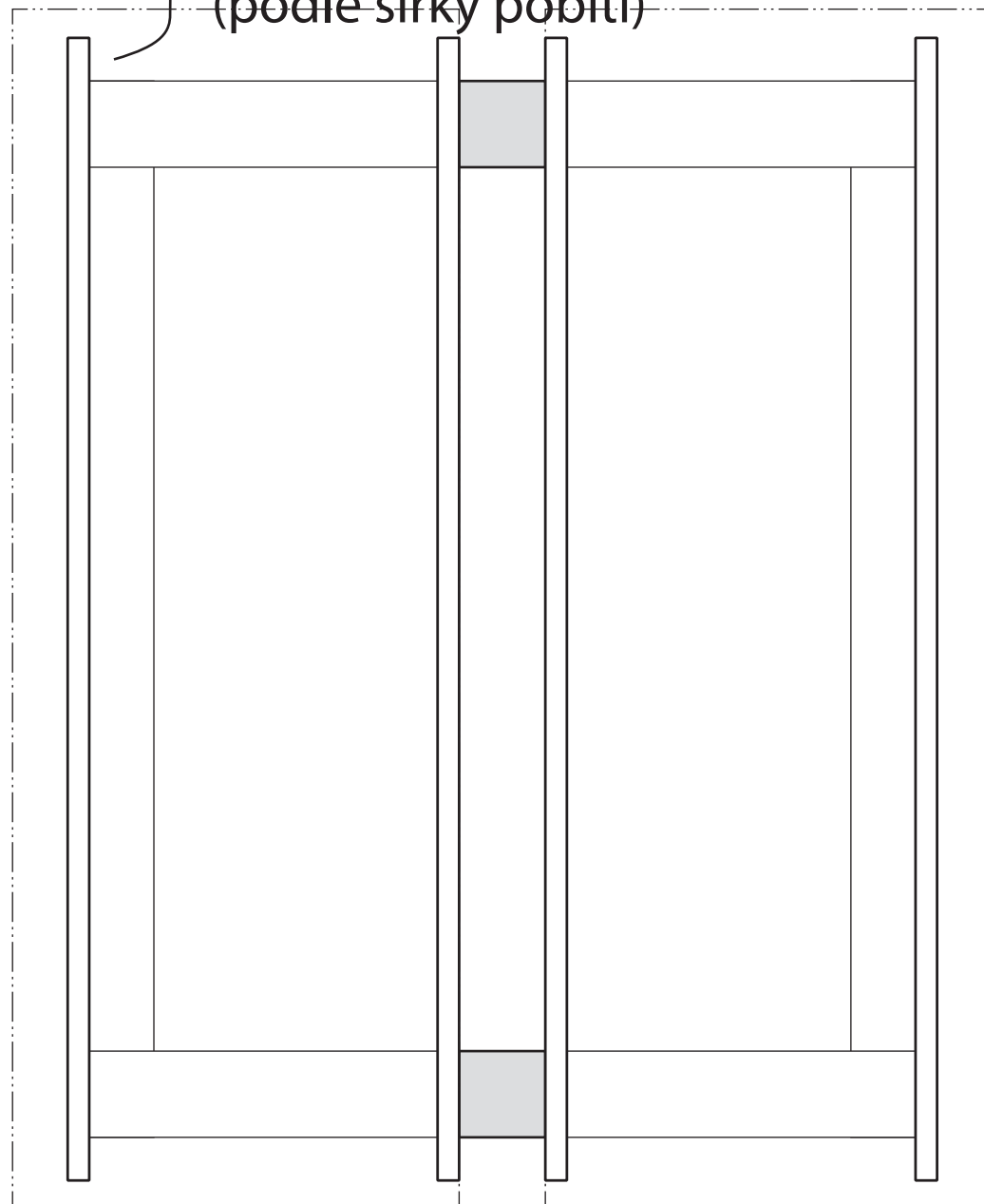

+ latě pro pobití „palubkama“

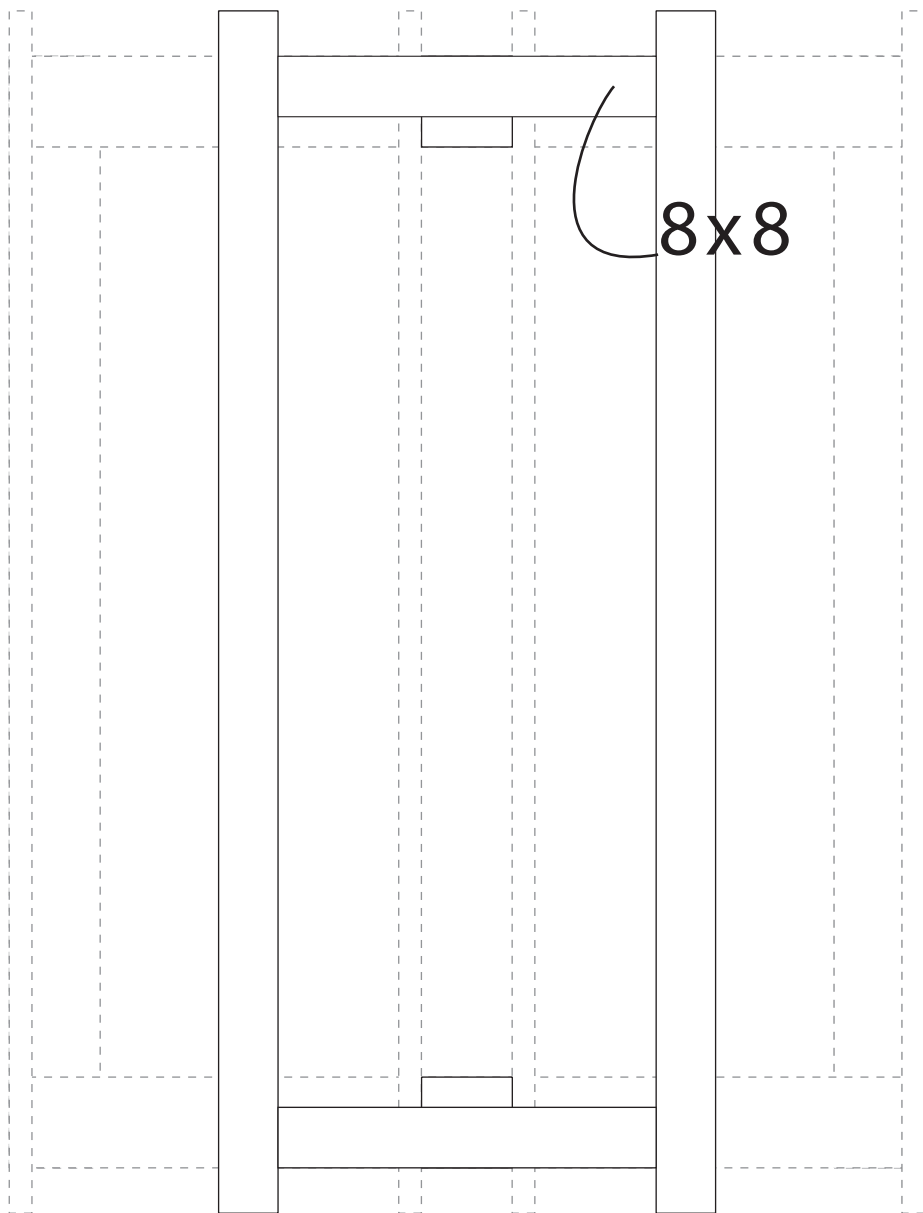

horní rám na horním konci sloupků

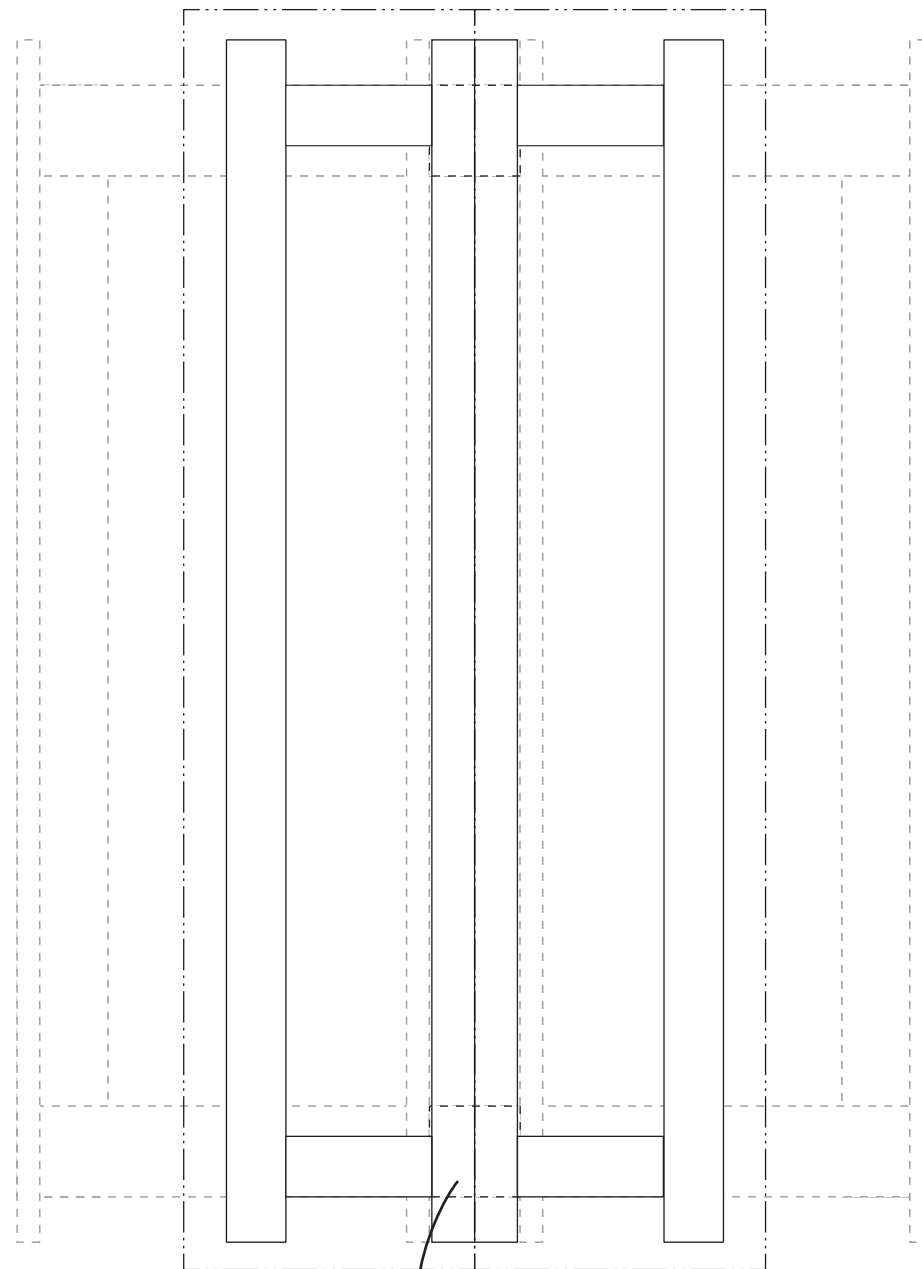

horní „krov“

8x8

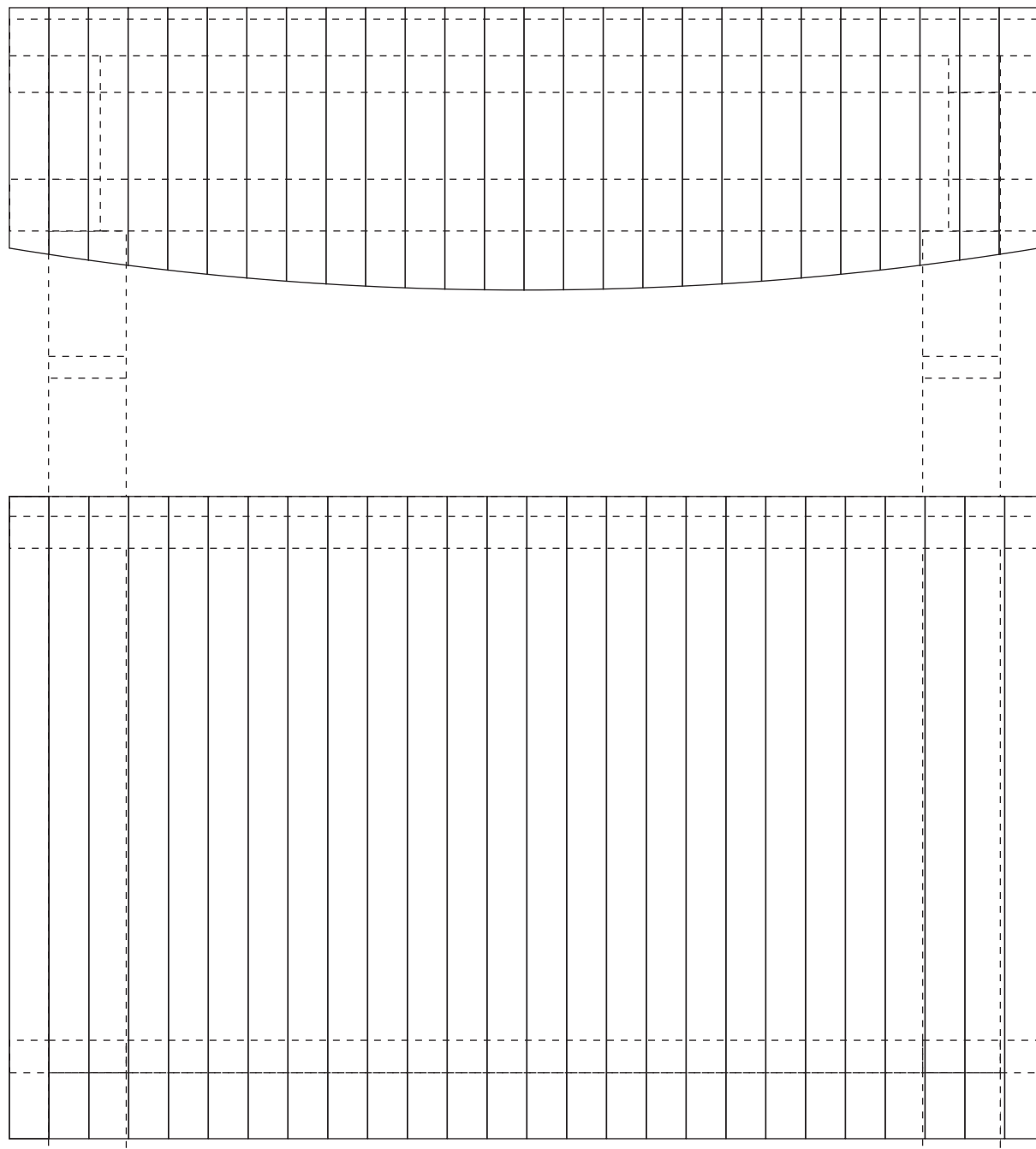

VARIANTA
spodní hrana
horní stříšky
je oblouk

$$r = 485 \text{ cm}$$