

Kuplena v spalni

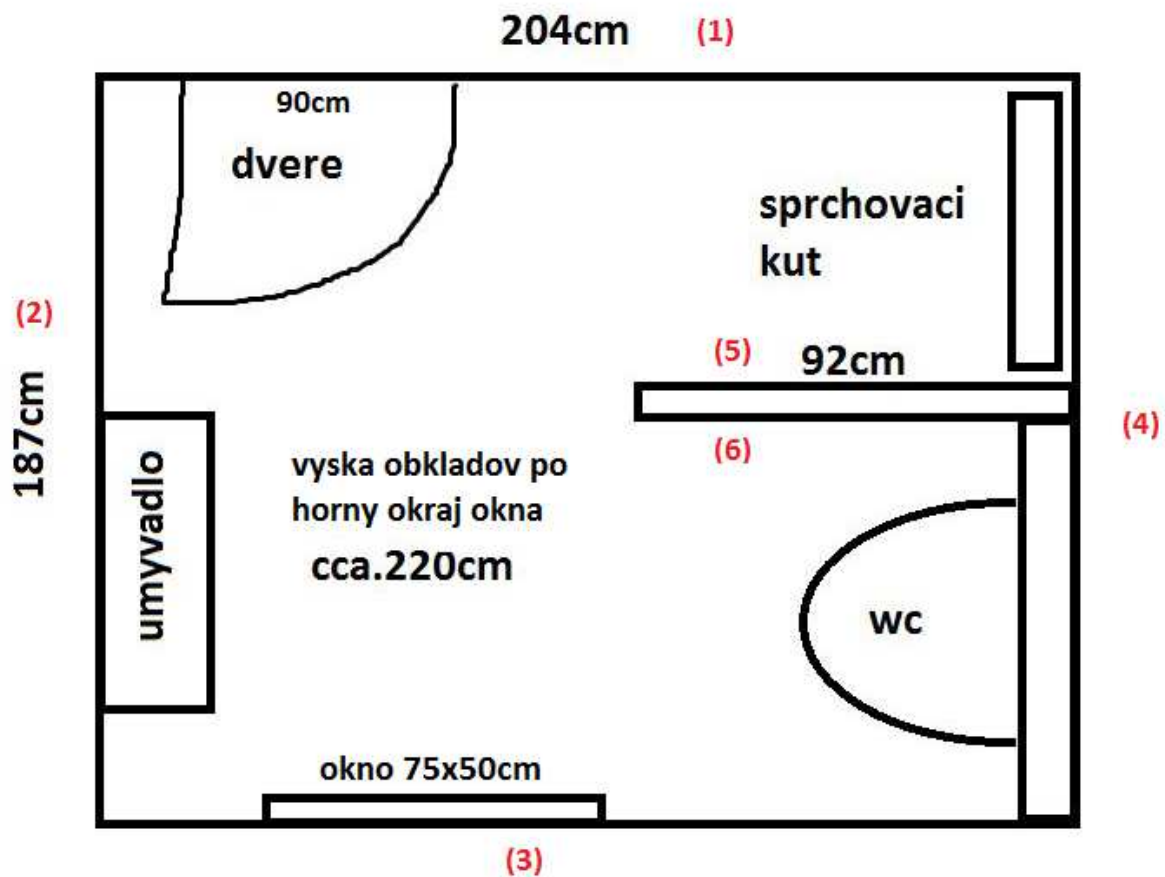

Plocha obkladu:

- (1) $2,04 \times 2,2 = 4,488 - (0,9 \times 2; \text{dvere}) = 4,488 - 1,8 = 2,688 \text{ m}^2$
- (2) $1,87 \times 2,2 = 4,114 \text{ m}^2$
- (3) $2,04 \times 2,2 = 4,488 - (0,75 \times 0,50, \text{okno}) = 4,488 - 0,375 = 4,113 \text{ m}^2$
- (4) $1,87 \times 2,2 = 4,114 \text{ m}^2$
- (5) $0,92 \times 2,2 = 2,024 \text{ m}^2$
- (6) $0,92 \times 2,2 = 2,024 \text{ m}^2$

SPOLU $19,437 \text{ m}^2 = 20 \text{ m}^2$

Plocha dlazby:

$$1,87 \times 2,04 = 3,81 \text{ m}^2$$

Kupelna

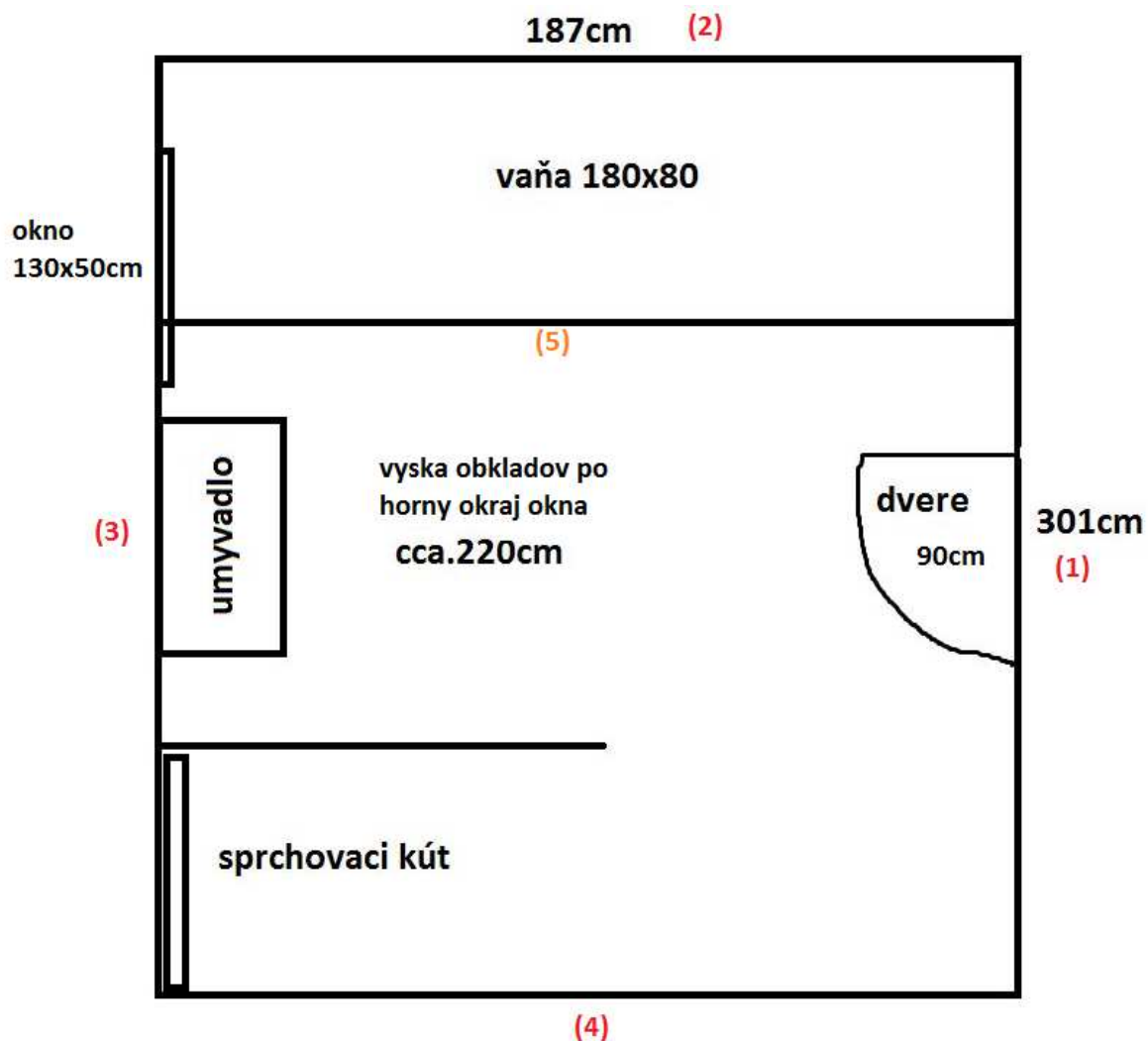

Plocha obladu:

- (1) $3,01 \times 2,2 = 6,622 - (0,9 \times 2; \text{dvere}) = 6,622 - 1,8 = 4,822 \text{ m}^2$
- (2) $1,87 \times 2,2 = 4,114 \text{ m}^2$
- (3) $3,01 \times 2,2 = 6,622 - (1,3 \times 0,5; \text{okno}) = 6,622 - 0,65 = 5,97 \text{ m}^2$
- (4) $1,87 \times 2,2 = 4,114 \text{ m}^2$
- (5) $1,87 \times 0,35 = 0,6545 \text{ m}^2$

SPOLU 19,6745 = **20 m²**

Plocha dlazby:

$1,87 \times 3,01 = 5,6287 - (1,87 \times 0,80; \text{vana}) = 5,6287 - 1,44 = 4,1887 = \mathbf{4,19 \text{ m}^2}$