

Total weight: 190,5 kg

Partlist continued in OP-drawing	Weight = 72,5 kg
Z1 1 Guiding racket for cable basket	27,5
4 6 Nut	0
3 12 Plain washer	0
2 6 Screw	0
1 1 PLS	4,5
1 Cable basket parts	0
1 G34-8-HB-A2-OP1	0

From	Mkuitinen
DATE	28.11.2001
TITLE	Cable basket
Specifiation	G34-8-HB-A2.dwg
Scale	1:10
Size	A2
Department	
Sum	
Weight	
Rev	

REQUIREMENTS for FABRICATION and MATERIALS	TKd
See Drawing	MKu
(Cook is Number of the Crane)	U-Im
B 21.01.091 Converted from Vertex,	
A 111201 Approved for production	
Rev Date Description	
Included in	

This document and the information contained herein, is the exclusive property of Konecranes. The said represents a non-patent, confidential and proprietary trade secret and may not be reproduced, copied or used in any way without the written consent of Konecranes. P. O. Box 100, Konecranes Heavy Utiling Corporation, Copyright © 2006 Konecranes Pte. All rights reserved.

KONECRANES

Drawing no. **G348-HB-A2**

Rev **B**

THE END OF TUBES
WILL BE FLATTENED

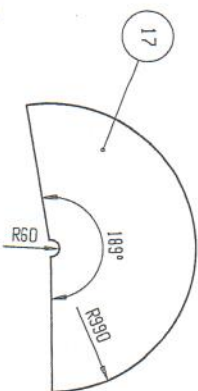
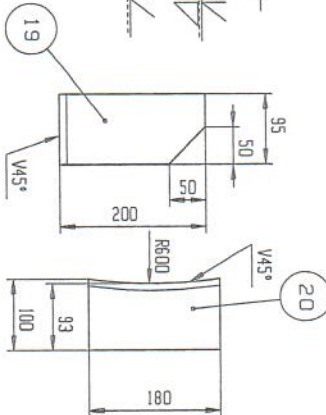
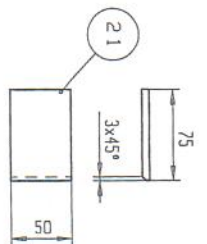
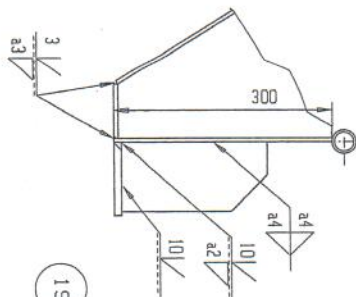
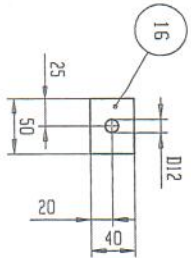
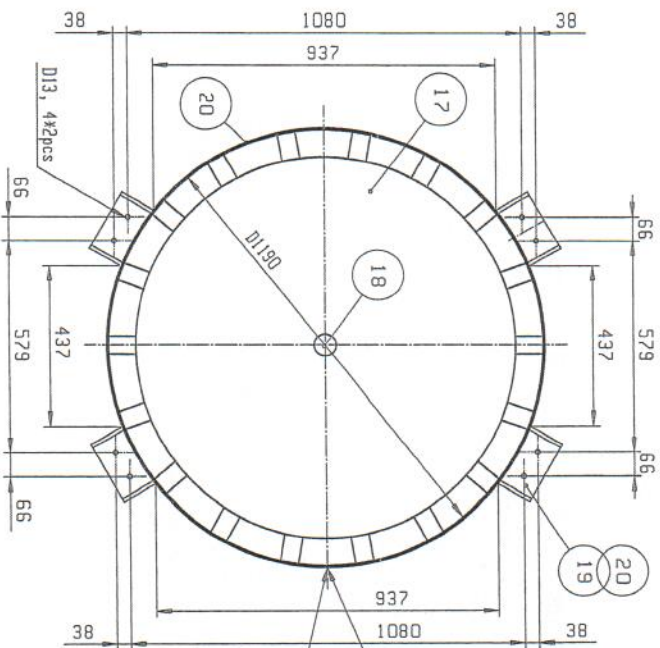
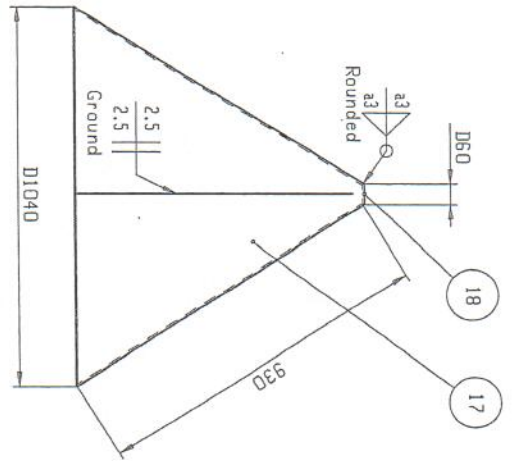
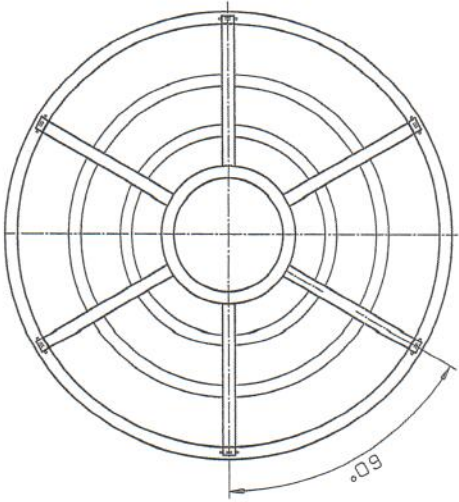
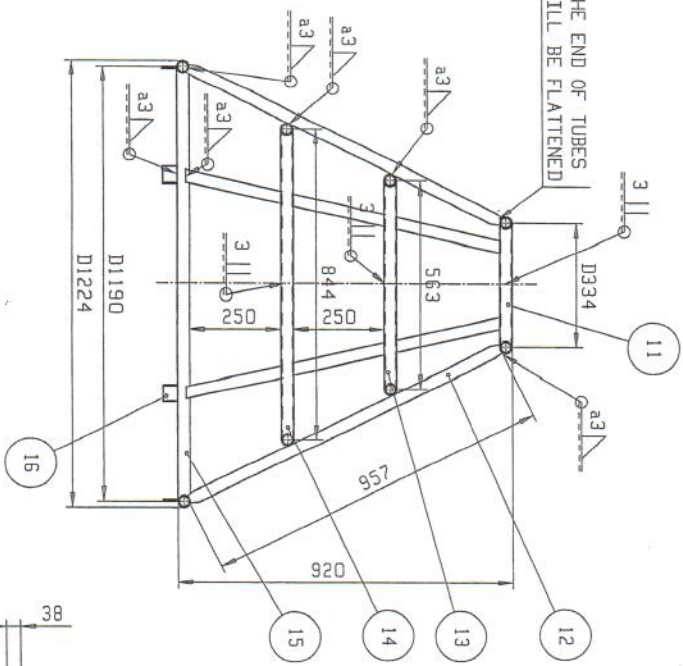

THIS DOCUMENT IS THE SOLE PROPERTY OF HANDBOOKS INC. COOPERATION. THIS DOCUMENT MUST NOT BE COPIED WITHOUT THE WRITTEN PERMISSION OF HANDBOOKS INC. COOPERATION. THIS DOCUMENT IS THE PROPERTY OF HANDBOOKS INC. COOPERATION. IT IS TO BE USED FOR ANY UNAUTHORIZED PURPOSE. COOPERATION WILL BE PROSECUTED.

WELDS AND TOLERANCES

See Drawing Gxxx-qf20
(Gxxx is Number of the Crane)

No	Qty	Description	Specification & Material	Scope	Unit Weight	Rev
20	4	FL10	S235JRG2		5.6	
19	8	PL10	S235JRG2		12	
18	1	PL5	S235JRG2		0.1	
17	1	PL5	1070x1980		63.6	
16	6	FLat bar	FL50x6x40		0.6	
15	1	Steel tube	D33.7x3.2 L=3770		9.1	
14	1	Steel tube	D33.7x3.2 L=2660		6.4	
13	1	Steel tube	D33.7x3.2 L=1770		4.3	
12	6	Steel tube	D33.7x3.2 L=950		13.8	
11	1	Steel tube	D33.7x3.2 L=1055		2.5	

Appd: 28.11.2001 Date: p_G348-HB-A2-OP1

Check: N. KUITTINEN

Dr: N. KUITTINEN

Scale: 1:10

Rev: A

KCI
KONECRANES VTC CORP.
FINLAND

Drawing no. G348-HB-A2-OP1

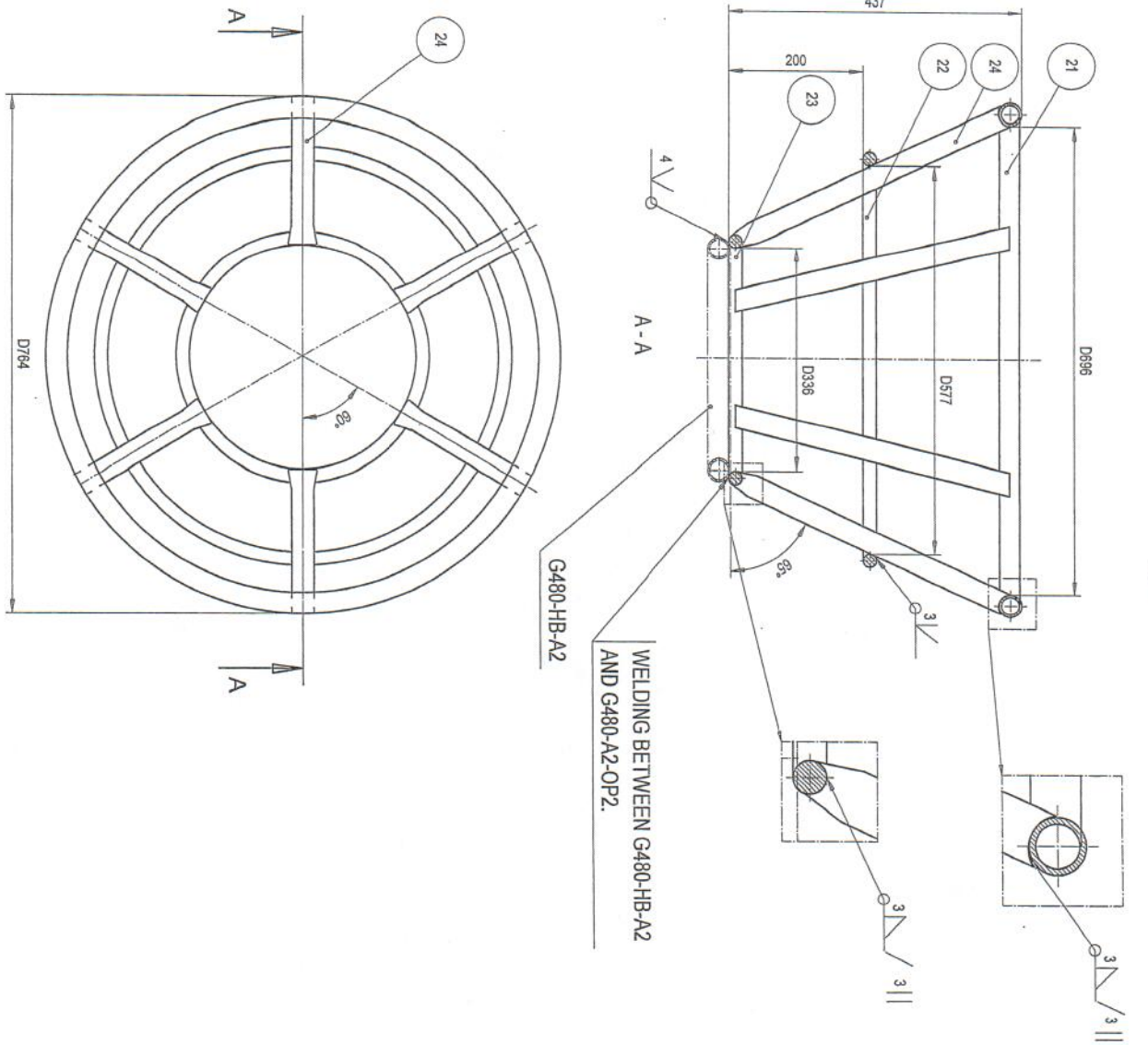

WELDING BETWEEN G480-HB-A2 AND G480-A2-OP2

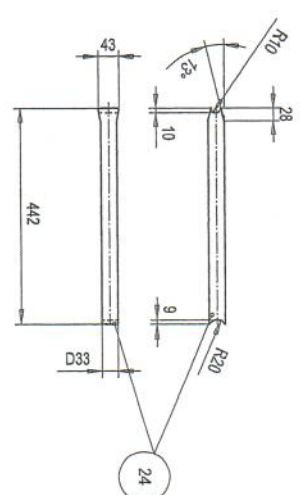
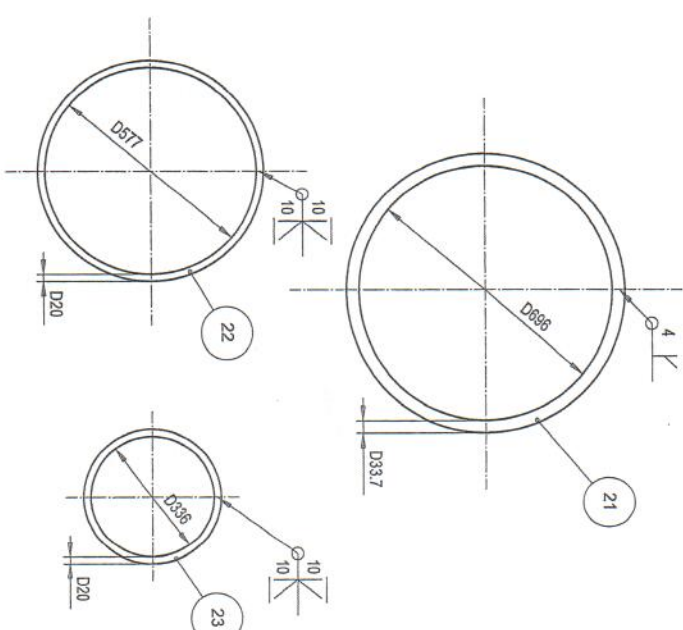

Part No.	Description	Quantity	Weight (kg)
21	6 TUBE	6	6.6
22	1 ROUND BAR	1	2.9
23	1 ROUND BAR	1	4.9
24	1 TUBE	1	1.1

THE BUYER ACCEPTS THE ACCURACY OF THE INFORMATION PROVIDED IN THIS DRAWING AND THE BUYER RELEASES THE SUPPLIER FROM LIABILITY FOR ANY DAMAGE OR INJURY TO PERSONS OR PROPERTY, OR TO ANY OTHER PROPERTY, ARISING OUT OF THE USE OF THIS DRAWING.

WELDS AND TOLERANCES
See Drawing G480-CP2
(Specify Number of the Class)

Rev	Date	Description	Drawn	App'd	Mk'd
A		Manufactured P.S. 21 Changed	P.S.		
A		Approved for production	P.S.		
Rev	Date	Description	Drawn	App'd	Mk'd
		G480-433			



Check	Drawn	App'd	Date	Part No.	Scale	Rev
	P.S.		14094	G480-HB-A2-OP2_b	1:10	A2
TITLE CABLE BASKET FOR						
Drawing No. G480-HB-A2-OP2						
						B