

TB128FR



**REDUCED
TAIL SWING
EXCAVATOR**

TAKEUCHI
Japanese for reliability

Operating Range and Machine Dimensions (mm)

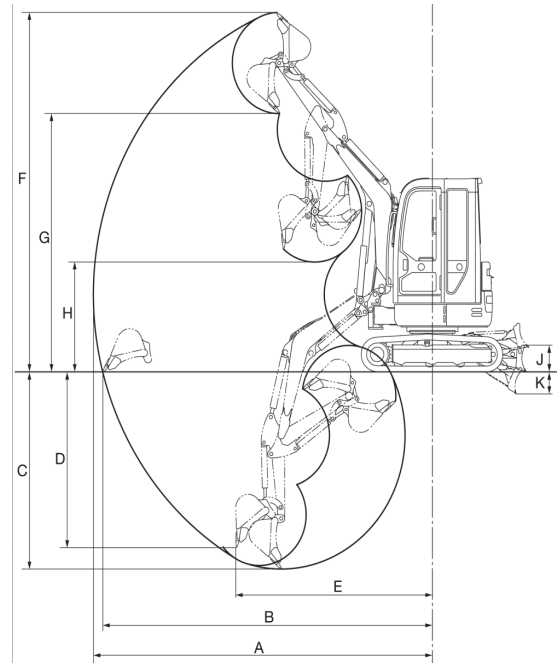
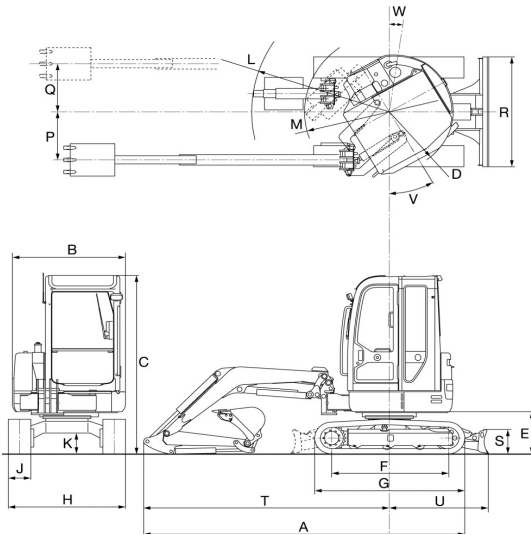

Dimensions	mm	
A	Overall Length	4275
B	Overall Width	1505
C	Overall Height	2530
D	Slew Radius	865
E	Clearance height	600
F	Crawler Base	1545
G	Crawler Overall length	2000
H	Crawler Overall Width	1560
J	Crawler Shoe width	300
K	Ground Clearance of undercarriage	300
L	Minimum radius	1805
M	Minimum radius at maximum front offset	1130
P	Offset Left	680
Q	Offset right	700
R	Dozer Blade Width	1560
S	Dozer Blade Height	350
T	Front distance to axis of rotation	3270
U	Dozer blade distance to axis of rotation	1320
V	Boom Offset angle left	30 °
W	Boom Offset angle right	15 °

Operating Range	mm	
A	Maximum Reach	4785
B	Maximum reach at ground level	4655
C	Maximum digging depth	2575
D	Maximum vertical digging depth	2150
E	Reach at maximum vertical digging depth	2775
F	Maximum height of cutting edge	4700
G	Maximum dump height	3380
H	Minimum dump height	1440
J	Dozer blades maximum height	320
K	Dozer blades maximum lowering	290

Weight	(kg)	Disel Engine (water-cooled)		Traction System	
Operating Weight	3360	Make	Yanmar	Crawler (Track)	Rubber
Performance		Model	3TNV82A	Track Width	300mm
Travel Speed (K/ph)	2.3/4.3	Rated Output (kW)/RPM	17.5/2400	Hydraulic System	
Slew Speed (rpm)	10	Maximum Torque (Nm)	85.3	Pump Type	2xVariable+2xGear
Maximum Gradeability	30° /58%	Displacement (cc)	1330	Hydraulic Flow Aux port (l/min)	50.6
Max Bucket Digging Force (Kn)	22.3	Cooling System (l)	4.3	Slew Motor	Axial Piston
Max Arm Digging Force (Kn)	15.8	Engine Lubrication (l)	3.6	Traction Motor	Axial Piston
Ground Pressure (kpa)	32.9	Fuel Tank (l)	39	Hydraulic System Capacity (l)	70

Offset Dig Function	
Type	Boom Offset
Swing Angle RH/LH	15° /30°

For More Information Locally

In accordance with our established policy of constant improvement. We reserve the right to amend these specifications at any time without notice. Photographs shown may feature non-standard equipment.