

# NM coupling

NM coupling consists of two hubs and flexible ring able to compensate all types of shaft misalignments. The flexible rings are made of Nitile rubber (NBR) which have a high internal damping characteristic which enable to absorb and dampen torsional vibrations, operate effectively in temperature range of -40 °C to +100 °C. The NBR material also resists to oil, dirt, grease, moisture, ozone and many chemical solvents.

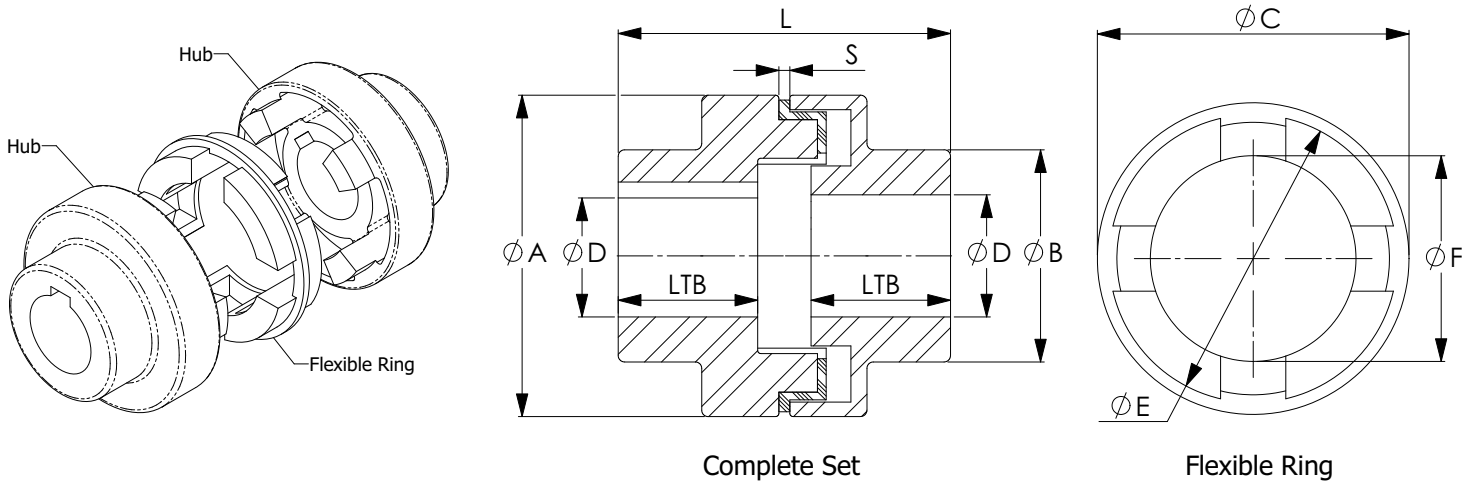

## Ratings and Dimensions

NM Size	Rated Torque		Max. Speed (RPM.)	Bore, D		Dimension (mm.)								Total Weight (kg.)	
	Normal (Nm.)	Max. (Nm.)		Min. (mm.)	Max. (mm.)	A	B	LTB	L	S	C	E	F		Number Of jaws
50	13	27	13,500	7	19	50	33	25	52.0	2.0 ± 0.5	49	44.5	31.5	4	0.48
67	22	45	10,000	9	28	67	46	30	62.5	2.5 ± 0.5	66	59.0	41.5	4	1.02
82	48	100	8,000	10	32	82	53	40	83.0	3.0 ± 1.0	81	73.5	50.5	4	1.88
97	96	200	7,000	12	42	97	69	50	103.0	3.0 ± 1.0	96	91.0	65.0	5	3.54
112	150	310	6,000	14	48	112	79	60	123.5	3.5 ± 1.0	111	104.0	75.5	6	5.40
128	250	500	5,000	18	55	128	90	70	143.5	3.5 ± 1.0	127	116.5	85.0	6	8.10
148	390	800	4,500	22	65	148	107	80	163.5	3.5 ± 1.0	147	135.0	105.5	7	13.50
168	630	1,300	4,000	28	75	168	124	90	183.5	3.5 ± 1.5	167	154.0	121.0	8	19.30

Remarks: 1. Splined, hex, round, set screw or keyway bore available at additional charge.

2. Coupling hub material is made of cast iron.

3. Find Rated Torque by :  $\text{Rated Torque (Nm.)} = \frac{\text{Power (kW)} \times 9550 \times K_1 \times K_2 \times K_3}{\text{Speed (RPM)}}$

**Table 1. Service factor.**

Operating type	Driven machine	K <sub>1</sub>
slightly shock	Centrifugal fan and pumps, agitator for light liquid, light generator, conveyor belt, brewing machinery.	1.5
Medium shock	Crane hoists, wood machinery, textile machinery, paper mill machinery, machine tools, centrifugal pump for loaded liquid.	1.8
Heavy shock	Crusher, shakers, calender, reciprocating conveyor, welding set, heavy rolling mill, rubber machinery.	2.0

**Table 2. Temperature factor**

Temp.range (°C)	Temp. Factor K <sub>2</sub>
- 40 to +30	1.0
+30 to +40	1.0
+40 to +60	1.0
+60 to +80	1.2
+80 to +100	1.3
+100 to +120	1.4

**Table 3. Start-up rate factor.**

Switching per hour	K <sub>3</sub>
Up to 120	1.0
120 to 140	1.3
More than 240	1.5