

SECTION B-B

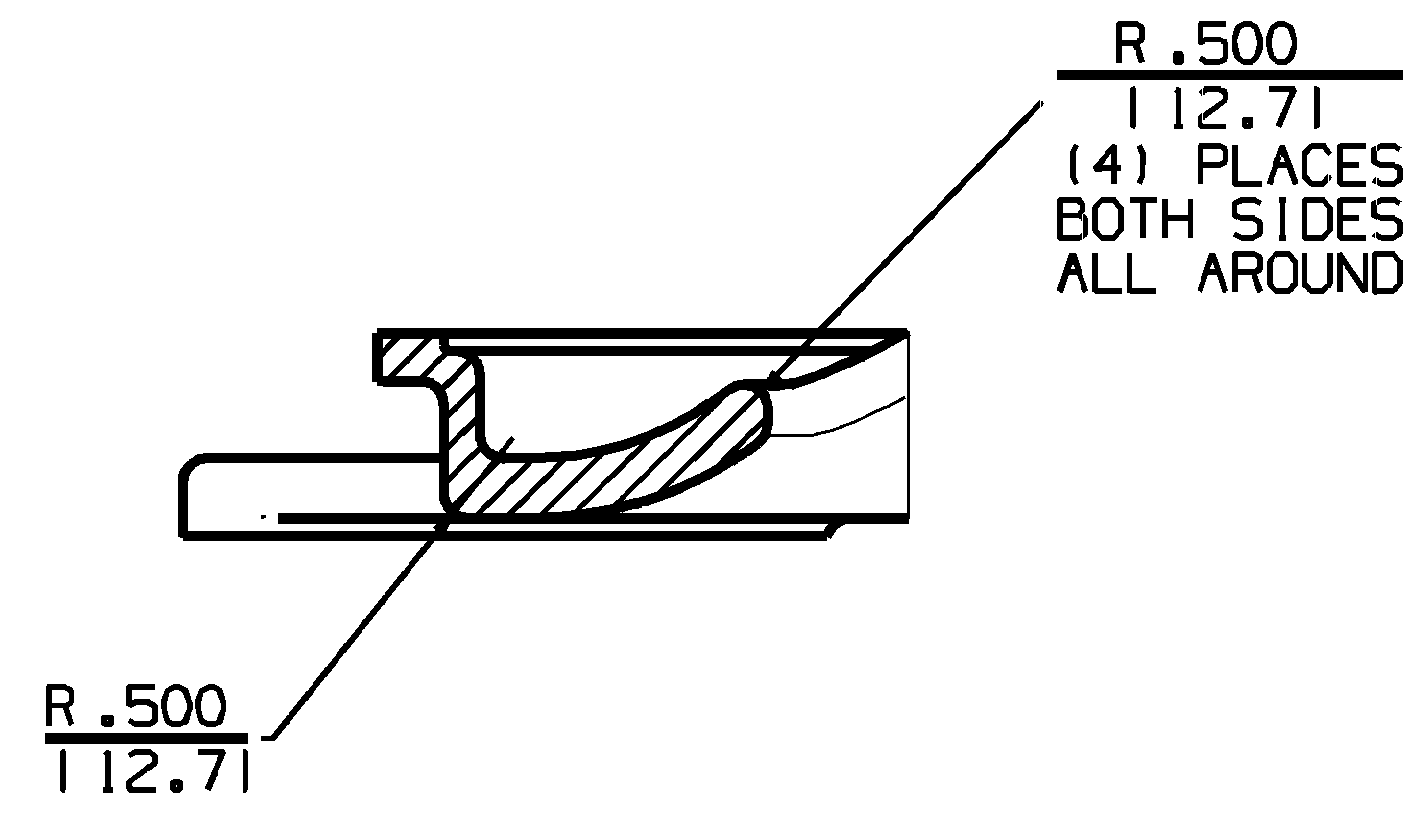

SECTION C-C

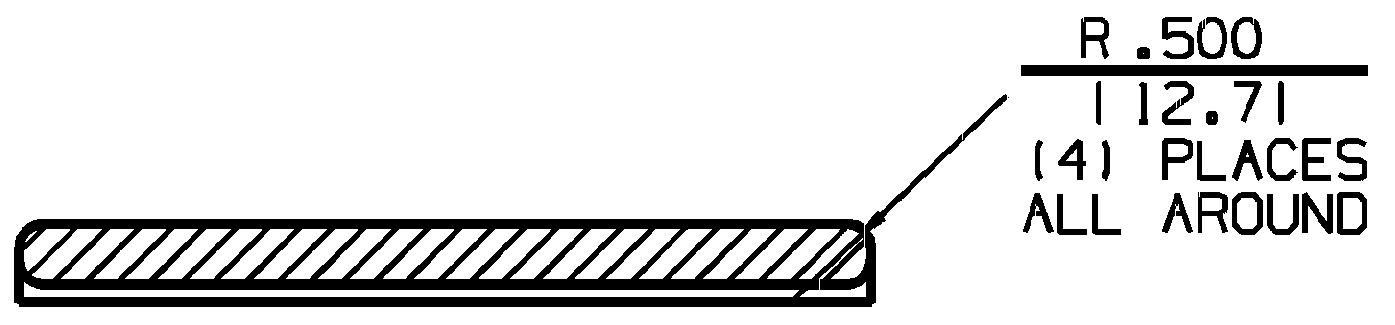

SECTION D-D

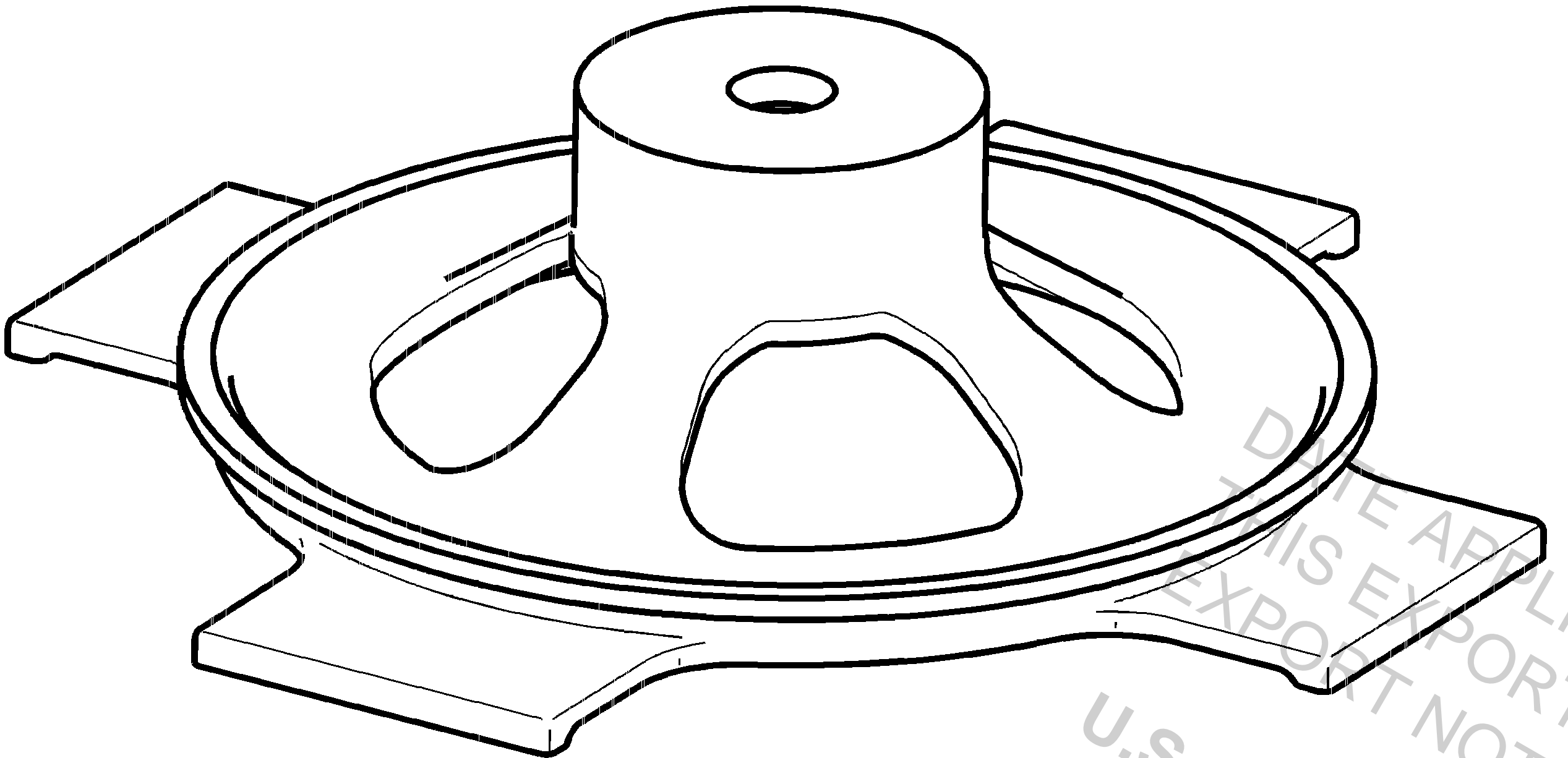

ISOMETRIC VIEW

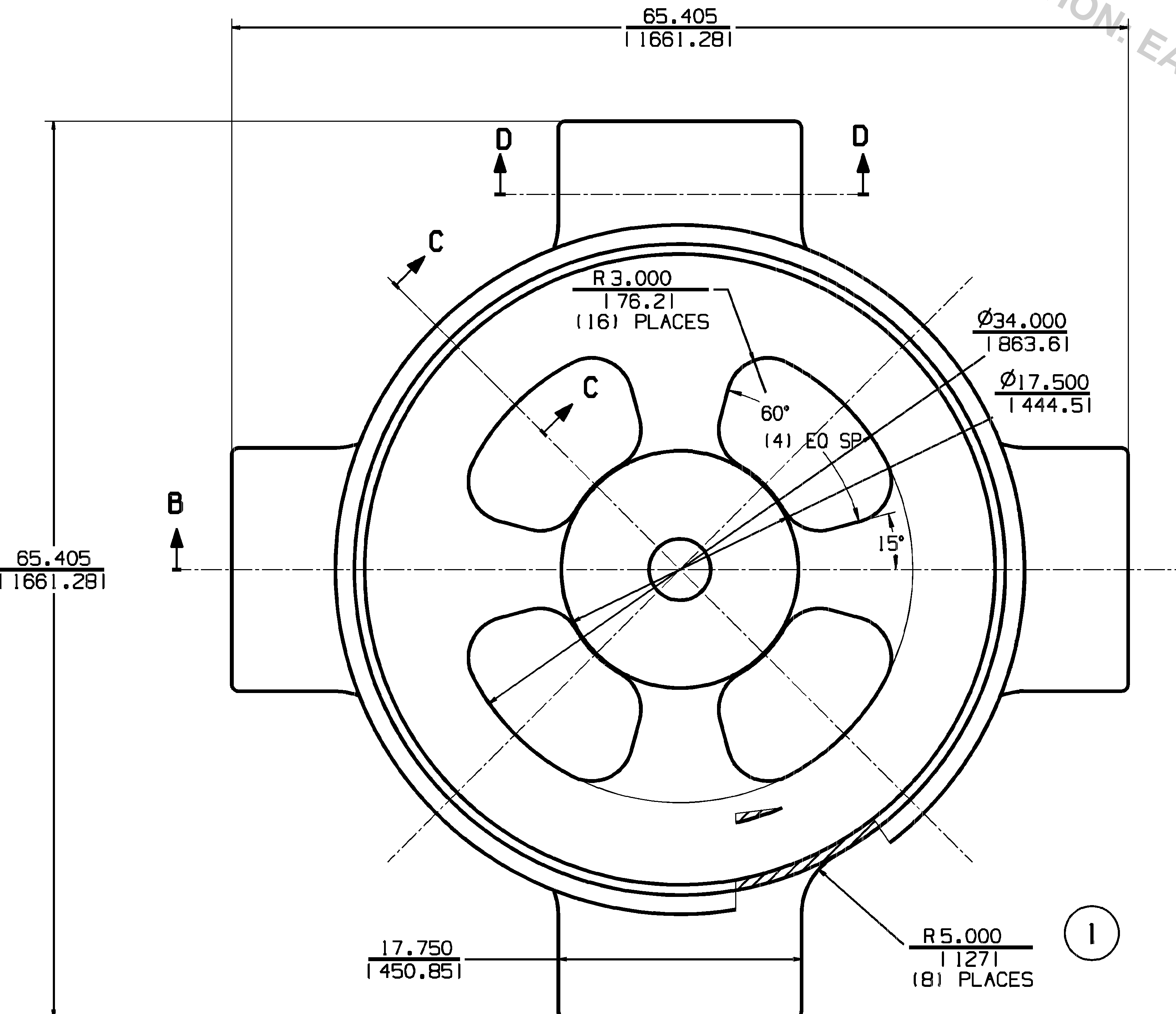

RADII WITHOUT DIMENSIONS:
.25±.1 (6.35±2.54)

CASTED PART:
MASS: 367 LBS (167 kg)
VOLUME: 3767 CU-IN (61,7 l)
MATERIAL: G-AlZn10Si8Mg

REVISIONS		DATE	CHECKED
BULLETIN NO.	ZONE		
11	A	11.585 WAS 2.085	
21	A	R 2.500 WAS R 1.500	
31	A	16.710 WAS 17.210	
41	A	6.210 WAS 6.710	
91	C	G-AlZn10Si8Mg WAS G-AlSi10MgCu-wd	
		12 FEB 04	FOOKE
		08 OCT 04	LEC

DATE APPLIED: 14-May-15

THIS EXPORT WATERMARK SUPERSEDES ALL EXISTING EXPORT NOTES DECLARED ON THE DRAWING.

U.S. EXPORT CLASSIFICATION: EAR 9E991

